



Galveston College

*Spring 2018*

Credit Class Schedule



[www.gc.edu](http://www.gc.edu)

## TABLE OF CONTENTS

President's Message/Board of Regents .....	3
Calendar .....	4
Getting Started .....	5
Important Notice for New and Readmitted Students .....	5
Dual Credit & Early Admissions Program .....	6
New Student Orientation .....	7
Registration Dates and Times .....	8
Testing and Registration .....	9
How to Register .....	11
Financial Aid and Scholarships.....	15
Veterans Benefits Program.....	16
Universal Access Scholarships.....	17
Tuition and Fees .....	18
How to Pay .....	19
Bookstore .....	22
Programs of Study Offered.....	23-24
Galveston College Map .....	25-26
Additional Student Information .....	27
Final Exam Schedule.....	29
How to Read the Course Schedule .....	30
2017 Mini Winter Schedule.....	31
Distance Learning.....	32
2018 Spring Course Schedule.....	33-58
2018 Spring Second Start Courses .....	59-61
Course Fees .....	62-69

## IMPORTANT PHONE NUMBERS

You may reach important College offices by dialing:

Admissions Office/Transcript Request.....	(409) 944-1230
Counseling Center.....	(409) 944-1220
Financial Aid .....	(409) 944-1235
Student Activities .....	(409) 944-1234
Special Services .....	(409) 944-1220
Instruction .....	(409) 944-1203
Distance Education.....	(409) 944-1324
Technical & Workforce Education.....	(409) 944-1404
Learning Resource Center .....	(409) 944-1240
Continuing Education .....	(409) 944-1344
Campus Security .....	(409) 944-1361
IT Service Desk .....	(409) 944-1352
Veteran Affairs Education Benefit.....	(409) 944-1225

# PRESIDENT'S MESSAGE

Dear Students and Supporters,

Galveston College is pleased to bring you the 2018 Spring Semester Credit Schedule. You are encouraged to take advantage of the learning opportunities available at your local community college.

Our excellent faculty are dedicated to offering you quality classroom, online, or hybrid courses designed to allow students to achieve success. You can earn your degree or certificate, gain workforce training, and take a variety of professional development or continuing education courses.

Join the number one community college in Texas this 2018 Spring Semester where we open doors and change lives.

Sincerely,

Dr. W. Myles Shelton



W. Myles Shelton, Ed.D.

## Board of Regents

*The nine-member Board of Regents of Galveston College is elected at-large by residents of Galveston Island, Port Bolivar, and Crystal Beach. These Regents give unselfishly of their time and represent their constituents for six-year terms.*



Raymond Lewis, Jr.  
Chairperson - Position 4



Karen F. Flowers  
Vice Chairperson - Position 3



Fred D. Raschke  
Secretary - Position 2

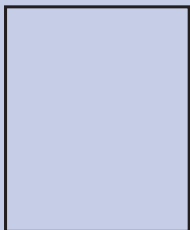

Vacant  
Position 7



Armin Cantini  
Position 9



Tino F. Gonzalez  
Position 1



Michael B. Hughes  
Position 5



Carl E. Kelly  
Position 8



Carroll G. Sunseri  
Position 6

## WINTER MINI CALENDAR

November 13.....	Early Registration Begins
December 8.....	Early Registration Payment Due/Drop for Non-Payment (Noon)
December 12 – 13.....	General Registration
December 14.....	Late Registration
December 15.....	Classes Begin
December 15.....	Last Day to Drop without Receiving a “W”
December 16 – January 2.....	Winter Break (College Closed)
January 4.....	Last Day to Withdraw with a “W” or Submit AWN
January 5.....	General Assembly (College Closed)
January 11.....	Final Exams
January 15.....	Grades Due to Admissions by 10:00 a.m.

## SPRING CALENDAR

October 31.....	New Student Orientation (10:00 a.m.)
November 9.....	New Student Orientation (3:00 p.m.)
November 13.....	Early Registration Begins
November 30.....	New Student Orientation (10:00 a.m.)
December 6.....	New Student Orientation (5:00 p.m.)
December 16 – January 2.....	Winter Break (College Closed)
January 4.....	New Student Orientation (10:00 a.m.)
January 4.....	Early Registration Payment Due/Drop for Non-Payment (Noon)
January 5.....	General Assembly (College Closed)
January 8 – 10.....	General Registration
January 11 – 12.....	Late Registration
January 15.....	MLK Day (College Closed)
January 16.....	Classes Begin
January 22.....	Last Day to Add/Drop Classes and for Financial Settlement
January 31.....	Last Day to Apply for Spring Graduation
January 31.....	Last Day to Drop without Receiving a “W”
March 12 – 16.....	Spring Break (College Closed)
March 30.....	Good Friday (College Closed)
April 12.....	Last Day to Withdraw with a “W” or Submit AWN
April 16.....	Early Registration for Summer/Fall Begins
May 3 – 9.....	Final Exams
May 10.....	Grades Due to Admissions by 10:00 a.m.
May 11.....	Graduation

## SPRING SECOND START

November 13.....	Early Registration Begins
February 9.....	Early Registration Payment Due/Drop for Non-Payment (Noon)
February 13.....	New Student Orientation (3:00 p.m.)
February 19.....	Classes Begin
February 28.....	Last Day to Drop without Receiving a “W”
March 12 – 16.....	Spring Break (College Closed)
March 30.....	Good Friday (College Closed)
April 19.....	Last Day to Withdraw with a “W” or Submit AWN
May 3 -9.....	Final Exams
May 10.....	Grades Due to Admissions by 10:00 a.m.
May 11.....	Graduation

El horario de clases no se imprime en español, pero si usted necesita asistencia en español por favor llame al teléfono (409) 944-4242 y pida hablar con alguien en español y con gusto le ayudaremos.

# GETTING STARTED

## APPLYING FOR ADMISSION

For admission consideration to degree and certificate programs, new students need to complete the following steps:

1. Complete the Application for Admission and the Residency Questionnaire.
2. Submit official transcripts from home/high schools and colleges and universities attended.
3. If required, take appropriate placement tests and/or New Student Orientation.
4. Meet with a Counselor, Faculty Advisor, or Program Coordinator to discuss your degree plan and plan your class schedule.
5. Submit evidence of the Bacterial Meningitis vaccination.
6. Register and pay for classes using Whitecaps portal or in person.

## READMISSION

Previously enrolled students who have not attended Galveston College for at least one semester (not including summer sessions) must reenroll by completing and submitting a Readmission Application to the Office of Admissions located in Moody Hall. The Readmission Application can also be downloaded online at [www.gc.edu](http://www.gc.edu). Students who have been away from GC for one year or more must reapply by completing a new Admission Application and the Residency Questionnaire.

## IMPORTANT NOTICE FOR NEW AND READMITTED STUDENTS

Pursuant to the Jamie Schanbaum and Nicolis Williams Act, all entering students to an institution of higher education or private or independent institution after January 1, 2012, MUST show evidence of being immunized against bacterial meningitis. (Texas Education Code 51.9192)

Entering student is defined as:

- a) A new student – a first-time student in an institution of higher education, or the private or independent institution of higher education, including a student who transfers to the institution from another institution or
- b) A student who previously attended an institution of higher education before January 1, 2012 and is enrolling in the same or another institution following a break in enrollment of at least one fall or spring semester.

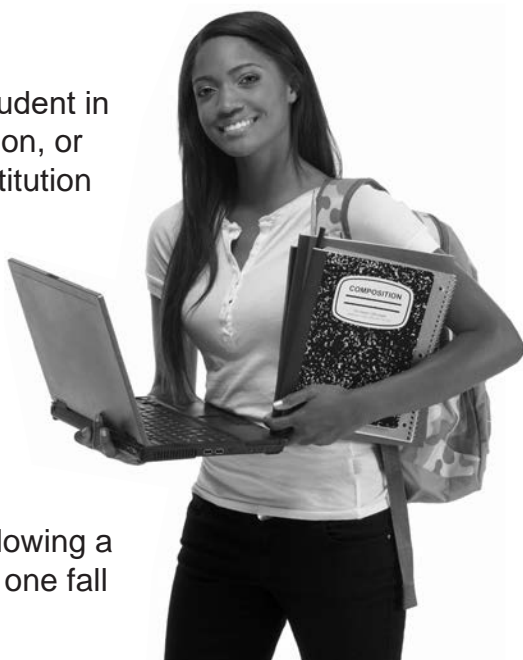

The bill exempts from the immunization a student who is enrolled only in online or other long distance education courses or who is 22 years of age or older. Other exemptions include:

- a) An affidavit from the physician stating that obtaining the vaccination would be injurious to the health or well-being of the student,
- b) An affidavit form by the student stating that he/she declines the vaccination for “reasons of conscience”, including religious beliefs.

Evidence of the vaccination must be during the five-years preceding and at least 10 days prior to the first day of the semester in which the student plans to enroll.

How to provide evidence of vaccination to Galveston College Office of Admissions:

- Submit a signed official notification from your physician indicating the month, day, and year the vaccination was administered, or
- Submit an official immunization record generated from a state or local health authority, or
- Submit a signed notification from your physician that obtaining the vaccination will be injurious to your health or
- Submit an affidavit that the student declines the vaccination for reasons of conscience.

Proof of your vaccination must be submitted to the Office of Admissions (M-160) in person, via email: [adm@gc.edu](mailto:adm@gc.edu) or via fax (409) 944-1501.

For additional information, please visit

[www.collegevaccinerequirements.com](http://www.collegevaccinerequirements.com)

## **DUAL CREDIT & EARLY ADMISSIONS PROGRAM**

Enrollment in Galveston College’s Dual Credit/Early Admissions Program provides high school students an opportunity to get a head-start on earning transferable college credits at a minimal cost **before** high school graduation. Contact Priscilla Culber at (409) 944-1251 for more information or visit [www.gc.edu](http://www.gc.edu).

**The Advantages of the Dual Credit & Early Admissions Program include:**

- Earn college credit while in high school.
- Courses are transferrable to four-year colleges and universities.
- Savings on tuition costs and fees compared to that of a four-year college.
- Seamless transition from high school to college
- Greater likelihood of success in subsequent collegiate work
- Greater likelihood of earning a high school diploma and a college degree
- Opportunity to access college facilities and resources such as tutoring services, computer labs and counseling services
- Enhanced skills required to be successful at the collegiate level such as time management skills, critical thinking skills, study skills and following directions and procedures.

**Qualifications for Dual Credit & Early Admissions:**

1. Must be classified as a high school student.

2. Complete the [Application for Admission](#) with the Residency Questionnaire or the online [Apply Texas application](#).
3. Demonstrate readiness for college coursework via the Texas Success Initiative (TSI) Assessment, ACT, SAT, STAAR End of Course Assessment, or other approved assessment. Please visit your high school counselor to ensure readiness standards are met.
4. Complete the [Dual Credit Enrollment Form](#) and obtain all signatures.
5. Submit an official high school transcript and an official test score report.

All completed and signed documents should be submitted to the Galveston College Dual Credit Advisor. The Dual Credit Advisor can be reached by telephone at 409-944-1251 or email at [pgonzale@gc.edu](mailto:pgonzale@gc.edu)

## NEW STUDENT ORIENTATION

New Student Orientation is **MANDATORY** for all first-time, full-time entering students registering for credit classes. All students are welcome and encouraged to attend. Students may choose either a face-to-face or online orientation. The schedule of face-to-face sessions is listed below. Please see the Online Orientation section for more details on that option.

<b>Tuesday, October 31, 2017</b>	<b>10:00 a.m.</b>
<b>Thursday, November 9, 2017</b>	<b>3:00 p.m.</b>
<b>Thursday, November 30, 2017</b>	<b>10:00 a.m.</b>
<b>Wednesday, December 6, 2017</b>	<b>5:00 p.m.</b>
<b>Thursday, January 4, 2018</b>	<b>10:00 a.m.</b>
<b>Tuesday, February 13, 2018</b> <i>(Second Start Orientation)</i>	<b>3:00 p.m.</b>



Orientation sessions provide students with information on the many services available at Galveston College. In addition students are also able to register early for courses.

- Students who are required to take the TSI Assessment ® cannot register for classes without taking the exam. It is strongly recommended you complete this exam prior to attending orientation.
- The TSI Assessment Examination requires a fee of \$29 and the completion of a pre-assessment activity prior to testing.
- See the Counseling Office to make your reservation for a session, check your TSI status and receive more information regarding the pre-assessment activity.
- Student Success Advisors are available on a walk-in basis to answer any questions you may have regarding the Admissions process, Financial Aid process, the Texas Success Initiative, New Student Orientation, and course selection.

Before paying for your exam, please make sure you complete the following:

- ✓ Reserve your space for New Student Orientation
- ✓ Speak with a Student Success Advisor regarding the pre-assessment activity
- ✓ Pick up your TSI examination form from the Counseling Center signed by an advisor
- ✓ Make your \$29 payment in the Business Office located on the 2nd floor of Moody Hall
- ✓ Present your examination form, your receipt of payment, and photo ID in the Testing Center to take the exam

All orientation sessions will be held in The Cheney Student Center, Seibel Wing. Visit [www.gc.edu](http://www.gc.edu) for more information. To sign up for a session call (409) 944-1220 or email Diane Laine at [dlaine@gc.edu](mailto:dlaine@gc.edu).

## NEW STUDENT ORIENTATION ONLINE

Galveston College has created an online version of the New Student Orientation in an effort to better serve our students. Students must have applied to Admissions and received their GC student ID number before being able to login to the Canvas system to complete the orientation. If you do not know your GC student ID number, please contact the Admissions Office for assistance.

Your Admissions acceptance letter provides details on how to access the Whitecaps Portal at <https://gccanvas.gc.edu/> to complete the pre-assessment activity for those students who must take the TSI Assessment test, as well as access to the online new student orientation. Please contact the Counseling Center at (409) 944-1220 if you have any questions pertaining to the online orientation.

## REGISTRATION DATES AND TIMES

### SPRING 2018

#### Early Registration\*:

November 13 –	8:00 a.m. – 7:00 p.m.	Monday – Tuesday
January 4	8:00 a.m. – 5:00 p.m.	Wednesday – Thursday

#### General Registration\*\*:

January 8 – 10	8:00 a.m. – 7:00 p.m.	Monday – Wednesday
----------------	-----------------------	--------------------

#### Late Registration\*\*:

January 11	8:00 a.m. – 7:00 p.m.	Thursday
January 12	8:00 a.m. – 5:00 p.m.	Friday

\*For Early Registration, payment must be made by 12:00 (noon) on January 4, 2018 to avoid being dropped from class.

\*\*For General and Late Registration, payment must be made on the day you register to avoid being dropped from classes.



# TESTING AND REGISTRATION

## REGISTRATION ALERT

Students may not register for classes until a Texas Success Initiative score is on file. Students may be required to take the TSI Assessment® test before enrolling in Galveston College.

## TEXAS SUCCESS INITIATIVE

The Texas Success Initiative (TSI) requires students to demonstrate college readiness in reading, writing, and mathematics by meeting certain criteria. The criteria include minimum scores on one of the following tests: TAKS®, STAAR, SAT®, ACT® or TSI Assessment®; or prior completion of identified college courses with a grade of "C" or higher. Official test score reports are required for placement/exemption. Students who do not demonstrate college readiness in any or all areas will be required to enroll in the appropriate developmental course(s). Galveston College offers the TSI Assessment test to meet the Texas Success Initiative requirement.

The test is available in the Learning Resources Center at Galveston College. Please contact the Counseling Center at (409) 944-1220 or the Testing Center at (409) 944-1290 for information on dates, times, and cost of the TSI Assessment test (valid picture I.D. REQUIRED for all testing).

## PLACEMENT TESTING

Each credit course in the Galveston College catalog (available on-line at [www.gc.edu](http://www.gc.edu)), has a required performance level in reading, writing, and/or mathematics skills. The TSI Assessment® test is used to determine placement in college level courses. Students who do not demonstrate the required performance level will be required to successfully complete the appropriate developmental course(s). **All students who place into two developmental level courses are required to enroll in PSYC 1300 – Learning Framework.** Contact the Counseling Center at (409) 944-1220 for information on the requirements for enrolling in credit courses.



## GALVESTON COLLEGE TESTING CENTER

The Testing Center provides support to the Galveston College community by accurately administering, reporting and securing assessments used by both the college and community. Services are offered in a clean, fair, comfortable and safe environment. The Testing Center is dynamic and strives to accommodate evolving testing and assessment needs. We adhere to the NCTA Professional Standards and Guidelines.

The Testing Center is equipped to provide computer generated and web based exams. Most exams are offered on a walk-in bases unless otherwise indicated below.

<b>Test:</b>	<b>Cost:</b>	<b>Registration Requirement:</b>
TSI Assessment <sup>®</sup>	\$29.00	Pre-Registration required through the Counseling Office
TSI Retest Per Section	\$10.00	Pre-Registration Via Counseling
CLEP <sup>®</sup>	\$85.00	Pre-Registration Required
	\$15.00	Galveston College Fee
CORRESPONDENCE	\$25.00	Pre-Registration <b>NOT</b> Required
DISTANCE EDUCATION	No Charge	Pre-Registration <b>NOT</b> Required
GED*	\$145.00	Pre-Registration Required (www.ged.com)
GED Re-Test	\$33.25	Per Subject Pre-Registration Required
NURSING		Pre-Registration required
PRE-ASSESSMENT (HESI)	\$80.00	Via Nursing Department
VCT PROCTORED		
EXAMS	\$25.00	Pre-Registration Recommended
ACCUPLACER Test	\$29.00	Pre-Registration Required

**A valid photo ID is required for admission for all exams.** For more information, check out the testing website at [www.gc.edu](http://www.gc.edu) or contact the Testing Center at (409) 944-1290.

\* The GED Exam is no longer offered as a pencil and paper exam. Online registration is available 24-hours a day at [www.ged.com](http://www.ged.com). Anyone who tested prior to January 2014 and did not pass or complete the exam must re-take the full exam. GED is only available to individuals who have not obtained a high school diploma from any school foreign or domestic.

Pre-Registration is only available through [www.ged.com](http://www.ged.com) or for online support contact:

<b>Test on computer questions</b>	1-877-EXAM-GED (877-392-6433)
<b>Preguntas en Español</b>	1-877-450-3276

# HOW TO REGISTER FOR CLASSES

Galveston College has implemented a new student information system – **Whitecaps Portal**. This system provides students with immediate and ongoing information about programs and services available at the College as well as online access to their individual courses and program of study status.

## REGISTER USING YOUR WHITECAPS PORTAL

### New Students

New students will be given access to the Whitecaps Portal for registration only after meeting with an advisor.

- Contact the Office of Admissions to verify that your records are complete.
- Prepare a draft class schedule to review with your Counselor, Faculty Advisor, or Program Coordinator.

Follow the instructions listed to register online.

### Continuing Students

- Register using the Whitecaps Portal during scheduled registration periods. Follow the instructions listed below. (Continuing and former students should also check with the Office of Admissions to remove any registration holds before meeting with a Counselor, Faculty Advisor, or Program Coordinator.)

### Returning Students

- Students who have not been enrolled for at least one long semester (spring, fall, or both summer semesters) will need to reapply to the college before being allowed to register. Please contact the Office of Admissions to reapply and update your student record.

Follow the instructions listed to register online.

### Ability to Benefit

- Students who have not received a high school diploma, GED, or Homeschool transcript and are enrolling in an eligible career pathway program may qualify for Ability-to-Benefit and receive Title IV funding to cover the cost of tuition and fees. To qualify for Ability-to-Benefit, students must take the ACCUPLACER test and score a 55 in Reading Comprehension, 60 in Sentence Skills, and 34 in Arithmetic. For more information, please contact the Financial Aid Office at (409) 944-1235.

## REGISTER ONLINE!

The following instructions are provided to assist with registering online:

- 1** Go to [www.gc.edu](http://www.gc.edu).
- 2** Click on **Whitecaps Portal**.
- 3** For continuing students, enter your GC User ID and password (the password is the same as your current campus computer password) and click login. For new students, enter “GC” followed by your 7 digit student ID number and password (the password is defaulted to your date of birth mmddyy) and click login. If you changed your password or need to reset it, contact the IT Help Desk at 409-944-1352.
- 4** Under Quick Links, select Register for Classes.

- 5 Select Search and Register for Classes.
- 6 Select a term, enter as many search criteria as you wish and click Submit.
- 7 To add a class, click the Select Section(s) box next to the sections you want to add and click Submit.
- 8 Select the appropriate action for all sections or for each section individually and click Submit.
- 9 Review your Registration Results and click OK.

Pay for your classes online by clicking the **FACTS\* Payment** tab.

*\* For more information about FACTS (payment online) turn to page 20.*

**Note:** The **Whitecaps Portal** will prohibit students from registering in courses when they have not completed the required prerequisite(s), lack the appropriate placement test score(s) and/or fail to enroll in the course co-requisite. Students are responsible for the development and accuracy of their class schedule.

Enrollment is complete only when tuition and fees are paid. Please contact the cashier in the Business Office for other methods of payment.

## SCHEDULE CHANGES

The **WHITECAPS PORTAL** is available for schedule changes during Early Registration and General Registration. Students who need to change their schedule (including adding or dropping a course) must contact a Counselor, Faculty Advisor, or Program Coordinator to have the change(s) approved during Late Registration. Some students may have restrictions on their ability to make changes.

## SENIOR CITIZEN DISCOUNT

All United States citizens who are residents of Galveston Community College District who have attained the age of 65 years (65 and older) are eligible to receive a 100% tuition discount for credit courses, and a 50% discount for associated fees for credit courses (exceptions include individual music instruction, course fees, liability insurance, health fees, and testing fees). Tuition/fee adjustment requests for credit courses must be made at the time of registration.

### SENIOR CITIZEN - CONTINUING EDUCATION COURSES

All United States citizens who are residents of Galveston Community College District who have attained the age of 65 years (65 and older) are eligible to receive a 50% tuition discount for non-credit continuing education courses. Tuition/fee adjustment requests for continuing education courses must be made at the time of registration.



## DEGREE AUDIT

You may view your degree progress in your Whitecaps Portal. A degree audit is a computerized evaluation report that compares completed, in progress, and transfer coursework against program requirements. An audit report is generated that reflects coursework compared to requirements of a declared major at Galveston College. The audit is unofficial and should be used only as a tool to assist with planning future coursework. Students are strongly encouraged to work closely with a Counselor, Faculty Advisor or Program Coordinator when interpreting the report.

New and continuing students can view their degree progress by following these instructions:

1. Log into your WHITECAPS PORTAL
2. Under Self Services, Select Academic Planning
3. Select Program Evaluation

Follow the instructions on the screen.

Students must be enrolled as a regular student in courses that count towards their active eligible degree or certificate program. Preplans are not considered eligible programs. Other courses, including prerequisites, cannot be used to determine enrollment status unless they are required remedial courses.

## ACADEMIC FRESH START

Academic Fresh Start entitles residents of Texas to seek admission to public institutions of higher education as undergraduate students without consideration of courses undertaken ten (10) or more years prior to enrollment. An applicant for admission who is a Texas resident may enter Galveston College pursuant to the "academic fresh start" status, Texas Education Code, §51.931. Applicants can request a Petition for Academic Fresh Start from the Office of Admissions.

- a) Fresh Start must be declared upon entrance to the College. Students who do not declare upon entrance will not be considered after enrolled.
- b) An applicant who elects to apply under this statute may not receive any course credits or grades earned for courses taken 10 or more years prior to enrollment.

*Notes: Academic Fresh Start does not apply to Financial Aid or VA benefits guidelines and/or regulations. Should the student seek admission under this option, then no college courses or credits ten (10) years or older will be evaluated. (A student's TSI exemption, based on work completed prior to the Fall of 1989, is retained even if a student elects to take advantage of the Academic Fresh Start program.) This option does not relieve students from notifying the college of attendance at previous institutions, nor of the need to submit transcripts indicating all previous course work attempted.*

## CARL PERKINS PROGRAMS

Galveston College provides eligible students with limited financial assistance for child care through Carl Perkins funding. This program is offered on a first come, first served basis to qualifying individuals, as funding is available. Qualifying individuals must be seeking a certification or degree in a technical program and demonstrate financial need. Applications are available in the Counseling Center. New applications should be submitted to the Counseling Center before or by the following deadlines to assure that enrollment is complete prior to the start of classes. Returning applicants MUST submit a renewal application (with notations, if a schedule is not available) by the deadline. Any returning student who requests child care after the deadline may not be reviewed until after classes have begun and awarded according to available funds.

### CHILD CARE PROGRAM:

Returning / New Participants:  
Friday, December 15, 2017



\*\*\*\*\*ONLY FULLY COMPLETED APPLICATION PACKAGES WILL BE ACCEPTED.\*\*\*\*\*

## **SPECIAL SERVICES**

Registration assistance and academic support are available for students with disabilities and for special populations. For further information and to register for services, students should contact the Counseling Center in Moody Hall at (409) 944-1220.

## **STUDENT ID CARDS**

**All Galveston College students are required to possess and display a valid Galveston College Student Identification card.**

Students must present their payment receipt, showing their name and student identification number, and a valid picture ID before a student ID card will be issued. Students having a Galveston College ID card will be given a current semester sticker upon showing their payment receipt. The Galveston College student ID card is required for college services such as the Library, Gym, the Student Success Center, and in the Testing Center. The initial ID card is issued at no cost to the student. Replacement ID cards are \$5.00 each. Students may obtain their ID card at the IT Service Desk, room R-120.

## **PARKING PERMITS**

All students, faculty, and staff at Galveston College are required to identify their motor vehicles on campus through the use of a Galveston College Parking Permit. Parking permits can be obtained anytime at no cost to the student with appropriate identification (driver's license) at the IT Service Desk in room R-120 by completing the appropriate form. For a complete listing of the Parking Rules and Regulations, go online to [www.gc.edu](http://www.gc.edu).

## **GALVESTON COLLEGE STUDENT SUCCESS CENTER**

The Student Success Center, located in N-119, provides free tutoring for any currently enrolled Galveston College student. Students must bring their college identification card (ID) to receive services such as: signing-in and signing-out, accessing the internet and checking-out textbooks and laptops that are available for check out within the Center only.

The College website (<http://www.gc.edu>) contains many links to valuable resources on the world-wide web for each discipline and for study skills. The facility offers

white boards for group studying and/or tutoring; it also offers sixteen computers designated for tutoring or virtual learning, and a positive learning environment.



# FINANCIAL AID & SCHOLARSHIPS

## FINANCIAL AID

Financial aid eligibility must be determined by one of the following methods:

- 1** Apply for Financial Aid by completing the 2017-2018 Free Application for Federal Student Aid (FAFSA) for Spring 2018 semester at [www.FAFSA.ed.gov](http://www.FAFSA.ed.gov)
- 2** If a student has NOT received a Financial Aid Award Notification for aid year 2017-2018 from Galveston College Financial Aid Office, the student must cover any balance that is owed and should contact the Business Office for payment options.
- 3** If a student has applied for financial aid and/or scholarships and has NOT received notification, the student may contact the Financial Aid Office to determine the status of their application. If a student's file is incomplete, the student will need to make payment arrangements at the time of registration from their own resources or set-up a FACTS payment plan with the Business Office. If Financial Aid is awarded during the semester, students will be reimbursed, if eligible.
- 4** If a student has not applied for financial aid: Tuition and fees must be paid from the student's own resources. An application packet may be picked up in the Financial Aid Office.

Federal regulations mandate that financial aid eligibility must be recalculated for students who withdraw during the semester, and who receive AWN's for non-attendance. A portion of financial aid used for tuition, fees, books, and cash disbursements **MAY HAVE TO BE REPAID** by those students. Students who fail to make the proper arrangements for repayment will be reported to the federal data system. This will prevent students from receiving aid from any school they attend in the future. Please see the Financial Aid Office for additional information.

## FREQUENTLY ASKED QUESTIONS

**When is the priority date to apply for financial aid?**

- The priority date for applying for Financial Aid for Spring 2018 is **November 8, 2017**.
- Students may still apply after this date, but will have to pay for their tuition and fees. Aid may be awarded retroactively after classes begin.

**Will financial aid pay for my books?** Books may be charged to Pell grants, loans and other scholarships in the College Bookstore. First-time Universal Access recipients will receive a one-time \$300.00 book stipend, must be used during the first semester of receiving Universal Access.

**Can I get financial aid if I am a part-time student?** Yes, in most cases.

**When are financial aid refund checks produced?** Refund checks are produced 14 calendar days after financial aid funds have been disbursed to the student's account, which is February 14, 2018 for Spring 2018. All refund checks will be mailed to the address on file with the Admissions Office.

**What scholarships are available and how do I apply?** Galveston College has scholarships available for students who fill-out applications, meet qualifications and are awarded through the scholarship committee. Galveston College offers several named scholarships for the Fall and Spring semesters. Contact the Financial Aid Office for details or visit the Financial Aid section of the college's website.

## **FINANCIAL AID ELIGIBILITY FOR LATE AND SECOND START COURSES**

- **Register for Second Start before the census date of the long semester**  
The tuition/fees and bookstore charges for students who register for 16 weeks courses and for Second Start or any class that starts after the census date of the long term, will be paid for by financial aid on the census date of the long semester. If the Second Start or (late starting course) is dropped by the student or cancelled by the administration before the start date of the course, the student is responsible for repaying any financial aid used to cover the charges incurred for the course.
- **Register for Second Start after the Census Date of the Long Semester**  
For students who register for Second Start courses only after the census of the long term, their financial aid will be packaged according to their hours enrolled. For students who are registered in a 16 weeks course(s) and who register for Second Start or any classes that starts after the census date of the long semester, the financial aid will be reassessed to accommodate the additional course hours for the Second Start course.

### **VETERANS BENEFITS PROGRAM**

The Financial Aid Office assists eligible student veterans and their dependents in obtaining veterans' educational benefits in compliance with Veterans Administration procedures and regulations. To receive veterans benefits, students must be admitted to Galveston College, enroll in a degree-seeking or certificate-seeking program and apply for Veterans Educational Benefits. Current students should visit or contact the Financial Aid Office each semester after registering for classes to verify their eligibility of benefits. For more information regarding Veterans Administration education benefits, contact the Financial Aid Office at (409) 944-1225.

### **FINANCIAL AID DISCLAIMER**

Students must be enrolled as a regular student in courses that count towards their active eligible degree or certificate program. Preplans are not considered eligible programs. Other courses, including prerequisites, cannot be used to determine enrollment status unless they are required remedial courses.



# UNIVERSAL ACCESS SCHOLARSHIPS

Since the Fall Semester of 2001, Universal Access Scholarships have ensured that every eligible graduate of a Galveston high school, home school program, and/or GED recipient has the opportunity to attend Galveston College to pursue a two year associate degree, take university transfer classes and/or receive technical training through an approved credit-earning workforce development program.

An applicant must be a resident of the Galveston College taxing district, as determined by the Admissions Office, for a minimum of 12 months prior to graduation or GED completion, and continue to be a resident of the Galveston College taxing district while enrolled at Galveston College and receiving Universal Access funds.

A recipient must be a resident of the state of Texas and a United States citizen or an alien who has filed with the proper federal immigration authorities a declaration of intention to become a citizen (Texas Education Code 54.057) allowing these students to qualify for resident tuition rates.

The maximum Universal Access Scholarship grant is \$3,600.00, for up to five years. In addition, there is a \$600.00 book stipend which must be utilized during the eligible student's freshman year. Book stipend will be available (\$300.00 each semester) during the first fall and spring semesters in which a student is enrolled. Complete Eligibility and Participation Guidelines for the program are available on request from the Financial Aid Office and online at [www.gc.edu](http://www.gc.edu). For more information, contact the Galveston College Foundation at (409) 944-1303 or 1306.

For financial aid assistance, contact the Galveston College Financial Aid Office at (409) 944-1235.



# TUITION AND FEES

SCHEDULE OF TUITION				FEES				TOTALS		
SEMESTER HRS.	RES. OF TEXAS	NON-RES. OF TEXAS	OUT OF DISTRICT FEE	BLDG. USE FEE	STUDENT SERVICES FEE	REGISTRATION FEE	GENERAL SERVICE FEE	IN DISTRICT TOTAL	OUT OF DISTRICT TOTAL	NON-RES. TOTAL
1	\$160	\$420	\$80	\$88	\$10	\$30	\$50	\$338	\$418	\$678
2	\$160	\$420	\$80	\$88	\$10	\$30	\$50	\$338	\$418	\$678
3	\$160	\$420	\$80	\$88	\$10	\$30	\$50	\$338	\$418	\$678
4	\$160	\$420	\$80	\$88	\$10	\$30	\$50	\$338	\$418	\$678
5	\$200	\$525	\$100	\$110	\$10	\$30	\$50	\$400	\$500	\$825
6	\$240	\$630	\$120	\$132	\$10	\$30	\$50	\$462	\$582	\$972
7	\$280	\$735	\$140	\$154	\$10	\$30	\$50	\$524	\$664	\$1,119
8	\$320	\$840	\$160	\$176	\$10	\$30	\$50	\$586	\$746	\$1,266
9	\$360	\$945	\$180	\$198	\$15	\$30	\$50	\$653	\$833	\$1,418
10	\$400	\$1,050	\$200	\$220	\$15	\$30	\$50	\$715	\$915	\$1,565
11	\$440	\$1,155	\$220	\$242	\$15	\$30	\$50	\$777	\$997	\$1,712
12	\$480	\$1,260	\$240	\$264	\$15	\$30	\$50	\$839	\$1,079	\$1,859
13	\$520	\$1,365	\$260	\$286	\$15	\$30	\$50	\$901	\$1,161	\$2,006
14	\$560	\$1,470	\$280	\$308	\$15	\$30	\$50	\$963	\$1,243	\$2,153
15	\$600	\$1,575	\$300	\$330	\$15	\$30	\$50	\$1,025	\$1,325	\$2,300
16	\$640	\$1,680	\$320	\$352	\$15	\$30	\$50	\$1,087	\$1,407	\$2,447
17	\$680	\$1,785	\$340	\$374	\$15	\$30	\$50	\$1,149	\$1,489	\$2,594
18	\$720	\$1,890	\$360	\$396	\$15	\$30	\$50	\$1,211	\$1,571	\$2,741
19	\$760	\$1,995	\$380	\$418	\$15	\$30	\$50	\$1,273	\$1,653	\$2,888
20	\$800	\$2,100	\$400	\$440	\$15	\$30	\$50	\$1,335	\$1,735	\$3,035

Minimum tuition for Residents of Texas is \$160 - Minimum tuition for Non-Residents of Texas is \$420 - Tuition per credit hour for Residents of Texas is \$40 - Tuition per credit hour for Non-Residents of Texas is \$105. Third Repeat course or Developmental course work that exceed 27 hours will be assessed at \$60 per credit hour surcharge. Non-Residents of Texas who are not located within the state of Texas, enrolled in distance education will be assessed at \$100 per credit hour surcharge.

## LABORATORY AND SPECIAL FEES

For Laboratory and course fees please see the Course Fee Schedule.  
Note: Fees are subject to change when circumstances warrant.

## SPRING CLASSES BEGIN JANUARY 16, 2018

### SPRING – REFUND POLICY (Credit Courses Only)

Under the rules promulgated by the Texas Higher Education Coordinating Board, Galveston College will refund tuition and applicable fees for withdrawals and dropped classes as scheduled below:

100% prior to January 16, 2018

70% prior to 5:00 p.m. on February 5, 2018

25% prior to 7:00 p.m. on February 12, 2018

NONE after 7:00 p.m. on February 12, 2018

**The \$30 registration fee is non-refundable at anytime.**

Student I.D. cards must be obtained by the 12th class day or there will be an additional \$5 charge.

A \$25 non-refundable late registration fee will be assessed for **Spring** credit course registration beginning January 11, 2018.

A \$10 non-refundable schedule change fee will be assessed for **Spring** credit course additions, drops, or changes beginning January 16, 2018.

**Note:** Tuition, fees and the refund policy listed in this schedule are accurate at the time of publication. Galveston College reserves the right to change its tuition, fees and refund policy wholly or in part during the semesters covering in the schedule.

## HOW TO PAY

Students can pay on campus in the Business Office by check, cash or credit cards. Galveston College accepts VISA, MasterCard, American Express and Discover. The Business Office is located on the second floor of Moody Hall at 4015 Avenue Q, Galveston, Texas. In addition, students can pay online using FACTS-eCashier payment plans.

To help you meet your educational expenses, we are pleased to offer FACTS as a convenient budget plan. It is not a loan; therefore you have no debt, there are no interest or finance charges assessed and there is no credit check.

The cost to budget monthly payments is a \$25.00 per semester nonrefundable fee. Please remember, all payments are deducted immediately! The FACTS Enrollment Fee is automatically deducted from your account WITHIN 14 days of your agreement being posted to the FACTS system.

### NOTICE

For Early Registration for Spring, payment must be made by 12:00 (noon) on January 4, 2018 to avoid being dropped from classes.

**During General and Late Registration, payment arrangements must be made on the day you register for classes to avoid being dropped from classes.**

For payment assistance, contact the Galveston College Business Office at (409) 944-1362.

# TUITION PAYMENT PLAN

## College Expenses, What's Your Plan?

Paying for the rising costs of a college education is a concern for many students and their family. The fact is, few of us have the resources to simply write a check for the full cost of tuition each semester. So how are you meeting your costs? What's your plan? Do you have one?

Having a solid plan for covering the cost of college is an important step toward graduation. Galveston College is pleased to enlist the services of FACTS to make the process easier for you.

Working together, Galveston College and FACTS will provide you with sensible strategies for covering the rising costs of college.

## Here is a Proven Plan

To help you meet your educational expenses, Galveston College is proud to offer FACTS as a convenient budget plan. This is not a loan program. You have no debt, there are no interest or finance charges assessed, and there is no credit check. The cost to budget your interest-free monthly payment plan is a \$25.00 per semester nonrefundable FACTS Enrollment Fee. You may budget your tuition and fees in the following ways:



**A. Automatic Bank Payment (ACH)**—ACH payments are those payments you have authorized FACTS to process directly with your financial institution. It is simply a bank-to-bank transfer of funds that you have pre-approved for your expenses at Galveston College. Payments may be made from either your checking or savings account. Payments are processed on the 5th of each month and will continue until the balance is paid in full.

**B. Credit Card Option**—Paying with your credit card gives you the option of taking advantage of any bonus programs that may be offered by your credit card company. Your monthly payment will be automatically charged to the credit card you designate. Payments will be charged on the 5th of each month until the balance.

## Convenient Online Payment Plan Enrollment (Fall and Spring only):

- Login on the Whitecaps Portal
- Click the quick link labeled "FACTS Payment Plan"
- (Note: Available for Fall and Spring terms **only**)
- Enter User ID (Enter a leading zero before ID)
- Enter Password (Must type forward slashes in between month, day, and year)
- Select Term
- Click "Calculate Tuition"
- Click icon labeled "E-Cashier"
- Select proceed to enter payment information
- Once completed print copy of agreement for your records

## FACTS ENROLLMENT DEADLINE

### SPRING 2018

\*Enrollment on e-Cashier is available for Early Registration from November 13 – January 4, 2018 at 12:00 Noon

\*Enrollment on e-Cashier is available for General Registration from January 8 – January 10, 2018

\*Enrollment on e-Cashier is available for Late Registration from January 11 – January 12, 2018

### FACTS Enrollment Deadlines

Last day to Submit Request	Required down payment	Number of Payments	Months of Payments
January 4 - Early Registration	50%	2	March & April
January 10 - General Registration	50%	2	March & April
January 12 - Late Registration	50%	2	March & April

## TUITION RESIDENCY CLASSIFICATIONS

1. A student is considered a **Texas Resident - In-District** resident if he/she has resided in the College taxing district for at least 12 months prior to the student's first registration at Galveston College for other than educational purposes.
2. A student is considered a **Texas Resident - Out-Of-District** resident if he/she has resided in the State of Texas for at least 12 months prior to the student's first registration at Galveston College for other than educational purposes and is not a resident of the College's taxing district.
3. A student is considered an **Out-Of-State/Non-Resident** student if he/she has NOT resided in the State of Texas for at least 12 months prior to the student's first registration at Galveston College for other than educational purposes.

The Board of Regents of Galveston College has authorized the waiver of the difference in the rate of tuition for nonresident and resident students for a person, or his or her dependents, who owns property which is subject to ad valorem taxation by the Galveston College District. The person, or his or her dependents, applying for such a waiver shall verify property ownership by presentation of an ad valorem tax statement or receipt, issued by the tax office of the Galveston College District, or by presentation of a deed, property closing statement, or other appropriate evidence of ownership of property which is subject to ad valorem taxation by the Galveston College District.

The responsibility of enrolling in courses under the proper residence classification is that of the student. If there is any question regarding the student's correct residency classification, it is the responsibility of the student to discuss this matter with the Registrar/Director of Admissions.

**Changes to tuition residency classification Must Be Submitted prior to or at the time of Registration.**

## CONCURRENT INSTITUTIONAL ENROLLMENT TUITION ADJUSTMENT

When a student registers at more than one public institution of higher education at the same time (i.e., enrolled at Texas A&M at Galveston and Galveston College or UTMB and Galveston College), the student may be eligible for a reduction in tuition. This adjustment will be in accordance with Section 54.0602 of the Education Code which establishes, in essence, that once a student has enrolled at one public institution, and paid the required minimum tuition, he/she will be charged tuition at the credit rate only when enrolling at a second public institution, and will not have to pay the minimum tuition charge a second time. **If a student is enrolled in 4 or more hours at Galveston College they are not subject to the minimum tuition requirement or the waiver.** In order to qualify, the student must bring a copy of their receipt for payment of tuition from the institution in which enrollment was first made by the 12th class day (for Fall and Spring semesters) or at the time of payment at Galveston College.

## FINANCIAL SUPPORT RECEIVED FROM A SPONSOR

The student must bring the required third party billing voucher issued by the sponsor to the Business Office by the census date for the term (varies by term). Voucher with missing, incorrect information, or received after the census date of the term will not be accepted.

## RETURNED CHECKS

All returned checks will be assessed a thirty-five dollar (\$35.00) handling fee. Upon receiving a returned check, the Business Office will place a "hold" on the student's record. A certified letter will be sent to the individual whose check is returned. This letter will set a final date for settlement of this returned check. After this date, the returned check will be sent to the District Attorney's office for legal action.

## STOP PAYMENT FEE:

Checks that are reissued as a result of being lost due to mishandling, mutilation, or incorrect address will result in a \$10 stop pay reissuance fee.

## BOOKSTORE HOURS

### SPRING 2018:

Monday & Tuesday	7:45 a.m. – 7:00 p.m.
Wednesday & Thursday	7:45 a.m. – 5:00 p.m.
Friday	7:45 a.m. – 3:00 p.m.

## BOOKSTORE REFUND AND EXCHANGE POLICY

- Texas Book Company will give full refunds for textbooks during the first five (5) days of the fall and spring semesters. Thereafter, a full refund will be given only through the twelfth (12th) class day with a receipt and a drop slip. **A cash register receipt must accompany all refunds and returns, and the current Texas Book Company price sticker must be affixed to the book.** Returns may be made within five (5) class days from the opening of each Summer semester.
- Study guides, syllabi and test preparation manuals are non-refundable.
- No refunds or exchanges are accepted on software, computers, and tablets.
- All other merchandise may be returned within three (3) days of purchase with a receipt. New materials must be returned in original condition. **Shrink-wrapped items may be returned for refund if unopened.** (Refunds are not allowed during the week prior to or during finals.)

## BUY BACK POLICY

As a service to students, the bookstore offers to buy back books on a daily basis. The following criteria determine prices paid for books:

- During the designated buyback period, the bookstore will pay up to 1/2 (one-half) of the retail purchase price for good condition books which are needed for sale in courses for the upcoming semester.
- Other days the offer may be less and will be based on wholesale purchase prices as published in the Textbook Buying Guide.

### Contact Information:

Phone Number: 409-944-1260

Fax: 409-944-1504

Email: bookstore@gc.edu

# Programs of Study Offered

## Degree Programs

### Transferable Degrees: Associate of Arts (A.A.) and Associate of Science (A.S.)

Associate Degrees at Galveston College require a minimum of 60 credit hours for completion. Each program will satisfy the requirements for the first two years of a four-year degree. Suggested programs of study for the Associate of Arts and Associate of Science degrees parallel the first two years required for Bachelor of Arts and/or Bachelor of Science degrees at senior colleges and universities. However, because degree requirements at senior colleges and universities vary, students should select courses with the assistance of a Galveston College Counselor or Faculty Advisor.

#### Galveston College offers an Associate of Arts degree in the following programs of study:

- Arts
- Criminal Justice
- Drama/Theatre
- English
- General Studies
- Health and Physical Education
- History
- Political Science
- Psychology
- Sociology/Social Work
- Speech Communications

#### Galveston College offers an Associate of Science degree in the following programs of study:

- Biology
- Business Administration
- Chemistry
- Computer Science
- Education/Teaching
  - EC-6 Generalist
  - Mathematics Ed. - High School Level
  - Mathematics Ed. - Middle School Level
- Engineering
  - Industrial Engineering
  - Mechanical Engineering
- General Studies
- Health Sciences
  - Allied Health - Clinical Lab Science
  - Allied Health - Occupational Therapy
  - Transfer Nursing
- Mathematics
- Physics
- Pre-Professional Health
- Psychology

### Associate of Applied Science (A.A.S.)

The Associate of Applied Science Degree (A.A.S.) is awarded to students who successfully complete an approved curriculum for a two-year technical or vocational program. Each program must include a minimum of 15 credit hours of general education courses with at least one course taken from each of the following areas: Humanities/Fine Arts, Behavioral/Social Sciences, and Natural Science/Mathematics. **In addition, evidence of computer literacy must be demonstrated.**

#### Galveston College offers Associate of Applied Science degrees in the following areas:

- Cosmetology
- Electrical & Electronics Technology
- Emergency Medical Services
- Heating, Ventilation & Air Conditioning (HVAC-R)
- Medical Administration
- Nuclear Medicine Technology
- Nursing
  - Associate Degree Nursing
  - EMT-P to ADN
  - LVN to ADN
- Radiation Therapy
- Radiography
- Surgical Technology
- Welding Technology

# Programs of Study Offered

## CERTIFICATE PROGRAMS

A certificate program of study is a program requiring less than 60 credit hours for completion. These programs are normally designed to provide the short-term training necessary to develop entry-level job skills without requiring completion of an Associate Degree. Credit may be awarded toward a respective degree at Galveston College on the vast majority of work taken in the certificate program.

### Galveston College offers the following Certificates:

- Computerized Tomography Technology
  - Entry
  - Advanced Level
- Cosmetology
  - Advanced Level Technology
- Cosmetology Instructor
- Culinary Arts
  - Entry
  - Advanced Level
- Electrical & Electronics Technology
  - Entry
  - Advanced Level
  - Advanced Level Technology
- Emergency Medical Technician
  - Advanced Level
  - Paramedic
- Heating, Ventilation & Air Conditioning (HVAC-R)
  - Entry
  - Advanced Level
  - Advanced Level Technology
- Law Enforcement
- Magnetic Resonance Imaging Technology
- Medical Coding
- Medical Office Assistant
- Radiation Therapy Technology
- Surgical Technology
- Vocational Nursing
- Welding Technology
  - Entry
  - Advanced Level
  - Advanced Level Technology

NOTE: Students interested in earning a second associate degree must complete a minimum of 18 additional hours in residence. A number of courses contained in the AAS degree programs are specifically created as workforce education courses and may not transfer to baccalaureate programs – see Counselors, Faculty Advisors, or Program Coordinators for more information.

### Advanced Technical Certificates

These certificates provide advanced studies in specific associate of applied science programs. Completion of the skills certificates enhances employability and offers specialized training. In most cases, students must complete an associate degree program to enroll.





# GALVESTON COLLEGE MAP

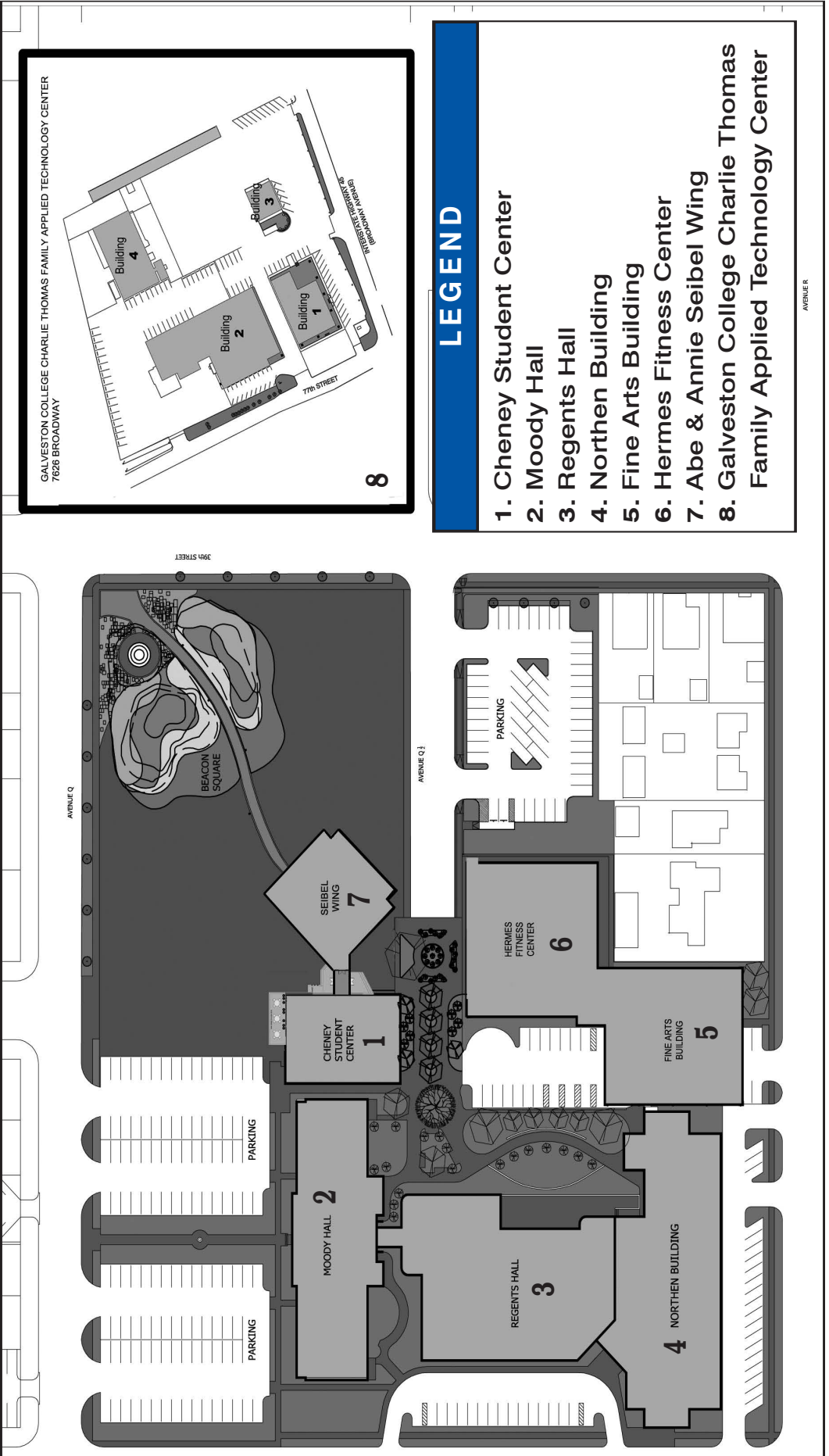

## LEGEND

1. Cheney Student Center
2. Moody Hall
3. Regents Hall
4. Northern Building
5. Fine Arts Building
6. Hermes Fitness Center
7. Abe & Annie Seibel Wing
8. Galveston College Charlie Thomas Family Applied Technology Center

# ADDITIONAL STUDENT INFORMATION

## STUDENT RECORDS

Under the terms of FERPA, Galveston College has established the following categories of information as Directory Information that may be released to the general public without the written consent of the student. A student may request that all or any part of the Directory Information be withheld from the public by making a WRITTEN REQUEST to the Office of Admissions during the FIRST FIVE (5) WORKING DAYS of a semester or the FIRST 4 DAYS of a summer semester. This request will apply only to the current enrollment period. The following is included as directory information:

- |  |   |  |
|--|---|--|
| a. Name  | h. Dates of attendance                            | n. Residency Status                      |
| b. Current and permanent address                     | i. Degrees and awards received                    | o. Photographs                           |
| c. Telephone listing                                 | j. Most recent and previous institutions attended | p. Sports participation                  |
| d. Date and place of birth                           | k. Courses currently enrolled in                  | q. Weight/height of athletic team member |
| e. E-mail address                                    | l. Number of hours enrolled in current semester   |  |
| f. Major/minor field of study                        | m. Classification                                 |  |
| g. Participation in officially recognized activities |   |  |

## STUDENT RIGHTS UNDER FERPA

The Family Educational Rights and Privacy Act (FERPA) affords students certain rights regarding their education records. The student's rights include:

- The right to inspect and review their records. The student may request to review his/her records by submitting a written request with student signature to the Registrar or other school official having custody of such records;
- The right to seek amendment of the student's records that the student believes are inaccurate, misleading, or otherwise in violation of the student's privacy right. Requests for amendment of records must be in writing and must describe the specific portions of specific record(s) the student wishes to have amended, text or instructions as to the change desired, and the reasons why the change is justified;
- The right to restrict the disclosure of Directory Information;
- The right to file a complaint with the Department of Education's Family Policy Compliance Office concerning alleged failures by the college/university to comply with the requirements of FERPA.

For further information regarding FERPA, please see the Galveston College catalog.

## ALCOHOL AND DRUG ABUSE INFORMATION AND REFERRAL PROGRAM

In compliance with the reauthorization of the Higher Education Act Program Participation Agreement required by institutions participating in programs of student financial assistance authorized under Title IV of the ACT, Galveston College provides alcohol and drug abuse information and referral. The information and referral is designed to aid students, faculty and staff. For more information, please contact the Counseling Center at (409) 944-1220.

**WARNING:** No alcohol or illegal drugs shall be allowed on campus. Any student caught with such a substance will be subject to suspension from attendance and/or enrollment and legal action, when appropriate. Students alleged to possess illegal drugs are guaranteed the rights of due process, (see Galveston College Website: [www.gc.edu/gc/Board\\_policies.asp](http://www.gc.edu/gc/Board_policies.asp)).

# **A Few Things You Need to Know About Your Classes at Galveston College**

- **WHITECAPS STUDENT EMAIL ACCOUNTS**

All students at Galveston College are given their own free Whitecaps email account. College personnel (including your instructors) use your Whitecaps email address to provide you with important information such as, “Please come by my office so we can discuss your latest assignment.” Since these are the kinds of emails a student does not want to miss, you need to activate your Whitecaps account. Simply go to the Galveston College webpage at [www.gc.edu](http://www.gc.edu) and click on the link that says, “How to Activate your Student Email Account -@whitecaps.” It’s that easy!

- **COMPUTER LABS/INTERNET ACCESS**

Many, if not most, of your classes at Galveston College are “Web Enhanced” and require that you have access to the Internet for certain aspects of your course. Don’t worry if you do not have access to the Internet from your home, Galveston College has many computer labs that operate at convenient hours throughout the week.

- **CLASS ATTENDANCE**

Students are expected to attend all lectures and laboratory periods, and an accurate record of each student’s class attendance is kept by each instructor for the duration of the course. Any student who has missed 10% of the total clock hours of instruction, not excused by the instructor, may be withdrawn from class by the instructor with a grade of “AWN”. Students are expected to report to class on time. At the discretion of the instructor, tardiness may be treated the same as an absence and the AWN policy may be applied

- **COMMITTED TO SAFETY**

Students who have experienced sexual assault, sexual violence, stalking, domestic violence, or other crimes may seek advice, assistance, and resources from the Vice President of Student Services, or the College’s Title IX Coordinator. The Title IX Coordinator’s duties include facilitating the complaint and investigation process. Individuals within these offices can assist the complainant with accessing medical or counseling services, advocacy services, social support services, legal services, and police services. Even in the absence of a formal complaint, the College may be able to provide assistance to the complainant with respect to his or her academic, living, transportation, or working situations. For example, a student might wish to explore changing a class or class time. For more information please visit the GC website: [http://www.gc.edu/gc/Staying\\_Safe\\_on\\_Campus.asp](http://www.gc.edu/gc/Staying_Safe_on_Campus.asp)

# FINAL EXAM SCHEDULE

## SPRING 2018

Final exam times are based on the first meeting time of class (e.g. if you meet at 8:00 a.m. on Monday or Wednesday, your exam time will be at 8:00 a.m. on Monday or if you meet at 9:30 a.m. on Tuesday or Thursday, your exam time will be at 8:00 a.m. on Thursday). (Note: Any alteration to the time or date of examinations on this published schedule must have prior approval from the Vice President of Instruction).

### DAY CLASSES

1st Meeting Time	Day	Exam Time
8:00 a.m.	M or W	8:00 a.m. on Monday, May 7
8:00 a.m.	T or R	8:00 a.m. on Tuesday, May 8
9:30 a.m.	M or W	8:00 a.m. on Wednesday, May 9
9:30 a.m.	T or R	8:00 a.m. on Thursday, May 3
11:00 a.m.	M or W	10:30 a.m. on Monday, May 7
11:00 a.m.	T or R	10:30 a.m. on Thursday, May 3
12:30 p.m.	M or W	10:30 a.m. on Wednesday, May 9
12:30 p.m.	T or R	10:30 a.m. on Tuesday, May 8
2:00 p.m.	M or W	1:00 p.m. on Wednesday, May 9
2:00 p.m.	T or R	1:00 p.m. on Thursday, May 3
3:30 p.m.	M or W	1:00 p.m. on Monday, May 7
3:30 p.m.	T or R	1:00 p.m. on Tuesday, May 8

Exams for all Friday classes will be May 4, 2018 (see instructor).

### EVENING CLASSES

1st Meeting Time	Day	Exam Time
5:30 p.m.	M or W	5:30 p.m. on Monday, May 7
5:30 p.m.	T or R	5:30 p.m. on Tuesday, May 8
7:00 p.m.	M	7:30 p.m. on Monday, May 7
7:00 p.m.	T	7:30 p.m. on Tuesday, May 8
7:00 p.m.	W	7:30 p.m. on Wednesday, May 9
7:00 p.m.	R	7:30 p.m. on Thursday, May 3

### ONLINE CLASSES

Students enrolled in online courses may be required to come to campus to take their final exam. Please refer to the course syllabus for the exact deadline on completing the final exam. Spaces are limited in the Testing Center so it is recommended that students take their final exams as early as possible during the exam period. Contact your instructor if you have questions.

### GRADES SUBMITTED

All grades are due in the Office of Admissions via the Whitecaps Portal by 10:00 a.m. Instructors should enter grades into Whitecaps Portal for processing as soon as possible following completion of the exam. Students should check all examination dates with their instructors prior to the exam week. Examinations should be administered in the room where the class meets, however, exam locations for off-campus classes will be announced by the instructor. Laboratory exams will be given on the last scheduled lab day of the semester.

# HOW TO READ THE COURSE SCHEDULE

## Room Symbols and Building:

These symbols are used in the class schedules each semester.

An explanation is as follows:

M-222 means Moody Hall, Room 222

N-240 means Mary Moody Northern Center, Room 240

R-300 means Regents Hall, Room 300

FA-207 means Fine Arts Building, Room 207

H-100 means Hermes Fitness Center, Room 100

AT means Charlie Thomas Family Applied Technology Center\*

## Schedule Codes:

M – Monday

T – Tuesday

W – Wednesday

R – Thursday

F – Friday

ARR - Arranged

LAB - Laboratory

HOSP - Hospital/Clinical

INTERNET - Internet Based

## Color Codes:

Day classes are indicated with a plain background.

Evening classes are indicated with a gray background.

Internet classes are indicated with a blue background.

**Please Note:** Courses offered, as well as course dates and times, are subject to change. For the most up-to-date version of the schedule, please consult the GC website at [www.gc.edu](http://www.gc.edu).

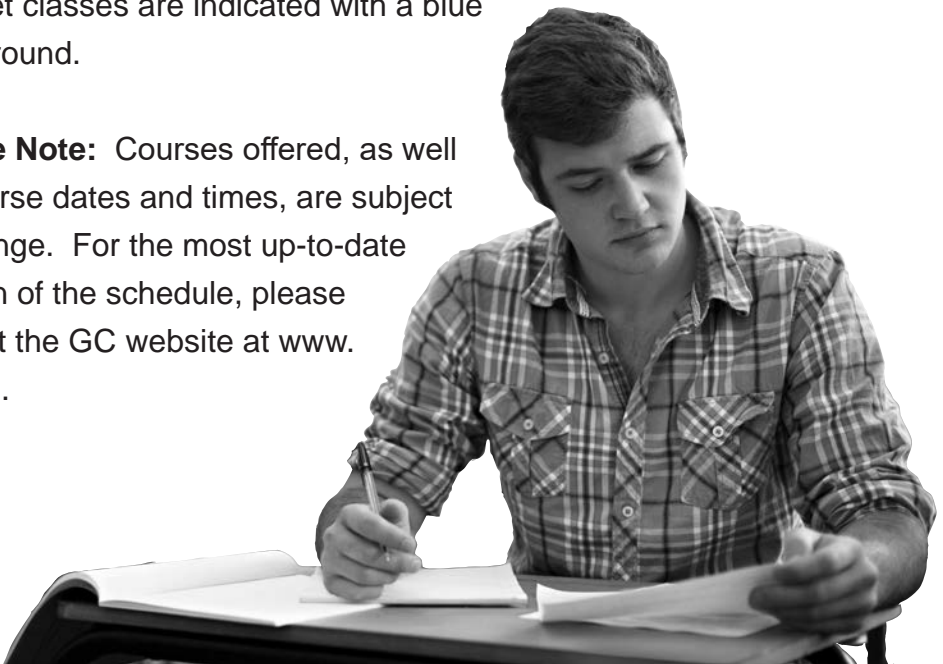

# WINTER MINI CLASS SCHEDULE

SUBJ	Course	Section	Course Title	CRD	Class			Laboratory			
					Start	Stop	Days	Room	Start	Stop	Days
<b>Winter Mini-Semester Classes begin 12/15/17 and end 1/11/18</b>											
<b>HUMANITIES</b>											
HUMA	1301	3400	Introduction to Humanities I	3	INTERNET						
Class meets 12/15/17 - 1/11/18. Contact instructor by first class day. Instructor email is mberberi@gc.edu											
<b>MATHEMATICS</b>											
MATH	1314	3400	College Algebra	3	INTERNET						
Class meets 12/15/17 - 1/11/18. Contact instructor by first class day. Instructor email is jwarren@gc.edu. Mid-term on 1/3/18 and Final on 1/11/18 must be taken face-to-face on the GC main campus with the instructor.											
<b>PHILOSOPHY</b>											
PHIL	2306	3400	Introduction to Ethics	3	INTERNET						
Class meets 12/15/17 - 1/11/18. Contact instructor by first class day. Instructor email is dlavivie@gc.edu											
<b>PHYSICS</b>											
PHYS	1401	3400	College Physics I	4	INTERNET					N-303	
Class meets 12/15/17 - 1/11/18. Contact instructor by first class day. Instructor email is dgebrese@gc.edu. Students will meet instructor for lab on Jan 8,9,10 and 11, 2018.											

## Winter Mini 2017 Classes Begin Friday, December 15, 2017 REFUND POLICY (Credit Courses Only)

Under the rules promulgated by the Texas Higher Education Coordinating Board, Galveston College will refund tuition and applicable fees for withdrawals and dropped classes as scheduled below:

- 100% prior to December 15, 2017
- 70% prior to 5:00pm on December 20, 2017
- 25% prior to 5:00pm on December 21, 2017
- None after 5:00pm on December 21, 2017

# DISTANCE LEARNING

## A FEW THINGS YOU NEED TO KNOW ABOUT DISTANCE LEARNING



- o An on-site orientation is sometimes required.
- o Contact your instructor by the first day of class; your instructor's email is provided in the course listing.
- o Distance Learning classes require self-discipline and good study habits. Additional information is located at [http://www.gc.edu/gc/Distance\\_Education.asp](http://www.gc.edu/gc/Distance_Education.asp)
- o A \$25 course fee will be charged per course for all Distance Learning courses. This includes both Hybrid and Internet courses.
- o You need access to the Internet in order to participate in these classes.
- o All first-time distance learning students are strongly encouraged to review the general orientation information for online learners. Orientation material is available from the eLearning website ([http://www.gc.edu/gc/DE\\_Orientation.asp](http://www.gc.edu/gc/DE_Orientation.asp)).
- o For questions or concerns regarding access issues with your online class, please contact the Distance Learning Coordinator at 409-944-1324.



# 2018 SPRING Credit Class Schedule



# SPRING 2018 SEMESTER

SUBJ	Course	Section	Course Title	CRD	Class			Laboratory			Instructor	
					Start	Stop	Days	Room	Start	Stop		Days
<b>ACCOUNTING</b>												
ACCT	2301	1100	Financial Accounting (Hybrid)	3	8:00 AM	9:20 AM	MW	N-217	INTERNET		INTERNET	DAVISON
ACCT	2301	1305	Financial Accounting (Hybrid)	3	7:00 PM	9:50 PM	T	N-217	INTERNET		INTERNET	DAVISON
ACCT	2302	1305	Managerial Accounting (Hybrid)	3	7:00 PM	9:50 PM	R	N-217	INTERNET		INTERNET	DAVISON
<b>ARTS</b>												
ARTS	1301	1005	Art Appreciation	3	11:00 AM	12:20 PM	MW	FA-320				STOVALL
ARTS	1301	1010	Art Appreciation	3	12:30 PM	1:50 PM	TR	FA-320				STOVALL
ARTS	1301	1710	Art Appreciation	3	7:00 PM	9:20 PM	TR	FA-319				GC FACULTY
Class meets 2/19/18 - 5/9/18.												
ARTS	1301	3100	Art Appreciation	3	INTERNET							KRESS
Contact instructor by first class day. Instructor email is lkress@gc.edu												
ARTS	1304	3100	Art History II	3	INTERNET							KRESS
Contact instructor by first class day. Instructor email is lkress@gc.edu												
ARTS	1311	1010	Design I	3	9:30 AM	12:20 PM	TR	FA-316	ARR			STOVALL
ARTS	1312	1015	Design II	3	9:30 AM	12:20 PM	TR	FA-316	ARR			STOVALL
ARTS	1316	1020	Drawing I	3	2:00 PM	4:50 PM	TR	FA-316	ARR			STOVALL
ARTS	1317	1025	Drawing II	3	2:00 PM	4:50 PM	TR	FA-316	ARR			STOVALL
ARTS	2316	1030	Painting I	3	12:30 PM	3:20 PM	MW	FA-316	ARR			STOVALL
ARTS	2317	1035	Painting II	3	12:30 PM	3:20 PM	MW	FA-316	ARR			STOVALL
ARTS	2346	1010	Ceramics I	3	12:30 PM	3:20 PM	TR	FA-323	ARR			JONES
ARTS	2346	1210	Ceramics I	3	5:30 PM	8:20 PM	TR	FA-323	ARR			JONES
ARTS	2347	1060	Ceramics II	3	12:30 PM	3:20 PM	TR	FA-323	ARR			JONES

# SPRING 2018 SEMESTER

SUBJ	Course	Section	Course Title	CRD	Class			Laboratory			Instructor			
					Start	Stop	Days	Room	Start	Stop		Days	Room	
ARTS	2347	1220	Ceramics II	3	5:30 PM	8:20 PM	TR	FA-323	ARR		Jones			
<b>BIOLOGY</b>														
BIOL	1322	3100	Nutrition and Diet Therapy I	3	INTERNET						Rudrabhatla			
Contact instructor by first class day. Instructor email is srudrabh@gc.edu														
BIOL	1322	3105	Nutrition and Diet Therapy I	3	INTERNET						Rudrabhatla			
Contact instructor by first class day. Instructor email is srudrabh@gc.edu														
BIOL	1322	3110	Nutrition and Diet Therapy I	3	INTERNET						Zivadinovic			
Contact instructor by first class day. Instructor email is dzivadin@gc.edu														
BIOL	1406	1010	General Biology I	4	8:00 AM	10:50 AM	T	R-375	8:00 AM	10:50 AM	R	R-375	Salazar	
BIOL	1407	1100	General Biology II (Hybrid)	4	INTERNET					2:00 PM	4:50 PM	M	R-375	Salazar
BIOL	2401	1600	Anatomy and Physiology I	4	8:00 AM	10:50 AM	M	R-370	8:00 AM	10:50 AM	W	R-370	Salazar	
BIOL	2401	1615	Anatomy and Physiology I	4	8:00 AM	10:50 AM	T	R-370	8:00 AM	10:50 AM	R	R-370	Zivadinovic	
BIOL	2401	1620	Anatomy and Physiology I	4	11:00 AM	1:50 PM	T	R-370	11:00 AM	1:50 PM	R	R-370	Salazar	
BIOL	2401	1625	Anatomy and Physiology I	4	7:00 PM	9:50 PM	M	R-370	7:00 PM	9:50 PM	W	R-370	Rudrabhatla	
BIOL	2402	1030	Anatomy and Physiology II	4	2:00 PM	4:50 PM	M	R-370	2:00 PM	4:50 PM	W	R-370	Rudrabhatla	
BIOL	2402	1031	Anatomy and Physiology II	4	2:00 PM	4:50 PM	T	R-370	2:00 PM	4:50 PM	R	R-370	Zivadinovic	
BIOL	2402	1035	Anatomy and Physiology II	4	11:00 AM	1:50 PM	M	R-370	11:00 AM	1:50 PM	W	R-370	Zivadinovic	
BIOL	2402	1215	Anatomy and Physiology II	4	7:00 PM	9:50 PM	T	R-370	7:00 PM	9:50 PM	R	R-370	Williams	
BIOL	2421	1040	Microbiology for Science Major	4	11:00 AM	1:50 PM	T	R-375	11:00 AM	1:50 PM	R	R-375	Rudrabhatla	
BIOL	2421	1210	Microbiology for Science Major	4	7:00 PM	9:50 PM	M	R-375	7:00 PM	9:50 PM	W	R-375	Zivadinovic	
<b>BUSINESS ADMINISTRATION</b>														
BUSI	2301	1010	Business Law	3	12:30 PM	1:50 PM	MW	FA-211					Hatcher	
BUSI	2301	1205	Business Law	3	7:00 PM	9:50 PM	M	FA-215					Glywasky	

# SPRING 2018 SEMESTER

SUBJ	Course	Section	Course Title	CRD	Class			Laboratory			Instructor		
					Start	Stop	Days	Room	Start	Stop		Days	Room
<b>CHEMISTRY</b>													
CHEM	1405	1000	Introductory Chemistry I	4	11:00 AM	12:20 PM	TR	N-338	2:00 PM	4:50 PM	R	R-378	Sanchez
CHEM	1405	1200	Introductory Chemistry I	4	7:00 PM	9:50 PM	M	N-338	7:00 PM	9:50 PM	W	R-378	Bytautas
CHEM	1411	1010	General Chemistry I	4	11:00 AM	12:20 PM	MW	N-338	2:00 PM	4:50 PM	W	R-378	Sanchez
CHEM	1412	1015	General Chemistry II	4	9:30 AM	10:50 AM	TR	N-338	2:00 PM	4:50 PM	T	R-378	Bytautas
CHEM	2425	1205	Organic Chemistry II	4	5:30 PM	8:20 PM	T	N-338	5:30 PM	8:20 PM	R	R-378	Sanchez
<b>COMMUNICATION</b>													
COMM	2366	1100	Introduction to Film (Hybrid)	3	9:30 AM	10:50 AM	MW	FA-214	INTERNET			Lacy	
Cross listed with DRAM 2366-1100.													
COMM	2366	3100	Introduction to Film	3	INTERNET			INTERNET			Lacy		
Cross listed with DRAM 2366 3100. Contact instructor by first class day. Instructor email is llacy@gc.edu													
<b>COMPUTED TOMOGRAPHY</b>													
CTMT	1291	3100	Special Topics in CT	2	INTERNET			INTERNET			Koebele		
Contact instructor by first class day. Instructor email is mkoebele@gc.edu													
CTMT	2336	3100	CT Equipment and Methodology	3	INTERNET			INTERNET			Koebele		
Contact instructor by first class day. Instructor email is mkoebele@gc.edu													
CTMT	2460	4500	Clinical I	4	ARR			ARR			Koebele		
Students taking CTMT 2460/2461 must have Program Director approval prior to start of semester.													
CTMT	2461	4500	Clinical II	4	ARR			ARR			Koebele		
Students taking CTMT 2460/2461 must have Program Director approval prior to start of semester.													
<b>COMPUTER SCIENCE</b>													
BCIS	1305	1100	Business Computer Applications (Hybrid)	3	11:00 AM	12:20 PM	MW	N-217	INTERNET			Way	

# SPRING 2018 SEMESTER

SUBJ	Course	Section	Course Title	CRD	Class			Laboratory			Instructor		
					Start	Stop	Days	Room	Start	Stop		Days	Room
BCIS	1305	3100	Business Computer Applications	3	INTERNET			INTERNET			Way		
Contact instructor by first class day. Instructor email is wway@gc.edu													
BCIS	1305	3700	Business Computer Applications	3	INTERNET			INTERNET			Way		
Class meets 2/19/18 - 5/9/18. Contact instructor by first class day. Instructor email is wway@gc.edu													
COSC	1301	1100	Introduction to Computing (Hybrid)	3	12:30 PM	1:50 PM	MW	N-217	INTERNET		Way		
COSC	1301	3100	Introduction to Computing	3	INTERNET			INTERNET			Way		
Contact instructor by first class day. Instructor email is wway@gc.edu													
COSC	1336	3100	Programming Fundamentals I	3	INTERNET			INTERNET			Way		
Contact instructor by first class day. Instructor email is wway@gc.edu													
<b>COSMETOLOGY</b>													
CSME	1355	2000	Artistry of Hair Design II	3	8:00 AM	4:30 PM	MTWRF	AT-105A	8:00 AM	4:30 PM	MTWRF	AT-115	Lungs
CSME	1547	2000	Principles of Skin Care/Facial	5	8:00 AM	4:30 PM	MTWRF	AT-115	8:00 AM	4:30 PM	MTWRF	AT-106	Villarreal
CSME	2310	2000	Advanced Haircutting	3	8:00 AM	4:30 PM	MTWRF	AT-105A	8:00 AM	4:30 PM	MTWRF	AT-115	Villarreal
CSME	2501	2000	Principles of Hair Coloring	5	8:00 AM	4:30 PM	MTWRF	AT-115	8:00 AM	4:30 PM	MTWRF	AT-115	Villarreal
<b>CRIMINAL JUSTICE</b>													
CRIJ	1306	1000	Court Systems and Practices	3	9:30 AM	10:50 AM	MW	FA-209	INTERNET		Pyle		
CRIJ	1306	3000	Court Systems and Practices	3	INTERNET			INTERNET			Pyle		
Contact instructor by first class day. Instructor email is mpyle@gc.edu													
CRIJ	1307	1000	Crime in America	3	9:30 AM	10:50 AM	TR	FA-209	INTERNET		Pyle		
CRIJ	2313	1000	Correctional Systems/Practices	3	11:00 AM	12:20 PM	TR	FA-209	INTERNET		Pyle		
CRIJ	2313	3000	Correctional Systems/Practices	3	INTERNET			INTERNET			Pyle		
Contact instructor by first class day. Instructor email is mpyle@gc.edu													
CRIJ	2314	1000	Criminal Investigation	3	11:00 AM	12:20 PM	MW				Pyle		

# SPRING 2018 SEMESTER

SUBJ			Course Section			Course Title			CRD	Class			Laboratory			Instructor	
	Course	Section		Start	Stop	Days	Room		Start	Stop	Days	Room	Start	Stop	Days	Room	Instructor
<b>CULINARY ARTS</b>																	
CHEF	1205	1000	Sanitation and Safety	3:00 PM	4:55 PM	MW	FA-211	2									Mendoza
CHEF	1301	1200	Basic Food Preparation	5:00 PM	10:00 PM	MTWR	FA-210	3						ARR			Mendoza
CHEF	1302	1200	Principles of Healthy Cuisine	5:00 PM	10:00 PM	MTWR	FA-210	3						ARR			Rodriguez
CHEF	1310	1000	Garde Manger	9:30 AM	2:30 PM	MTWR	FA-210	3						ARR			Mendoza
CHEF	1341	1000	American Regional Cuisine	9:30 AM	2:30 PM	MTWR	FA-210	3						ARR			Mendoza
CHEF	1345	1000	International Cuisine	9:30 AM	2:30 PM	MTWR	FA-210	3						ARR			Mendoza
CHEF	1380	4600	Coop Educ: Culinary Arts		ARR			3									Mendoza
CHEF	2302	1200	Saucier	5:00 PM	10:00 PM	MTWR	FA-210	3						ARR			Rodriguez
CHEF	2381	4600	Co-Op Chef Training		ARR			3									Mendoza
IFWA	1217	1000	Food Prod/Plan/Culinary Math	3:00 PM	4:55 PM	MW	FA-211	2									Mendoza
PSTR	1301	1200	Fundamentals of Baking	5:00 PM	10:00 PM	MTWR	FA-210	3						ARR			Rodriguez
SPNL	1291	1000	Spec Top in Span -Rest Spanish	3:00 PM	4:55 PM	MW	FA-210	2									Salinas
HAMG	2307	3100	Hospitality Marketing & Sales		INTERNET			3									Mendoza
Contact instructor by first class day. Instructor email is pmendoza@gc.edu																	
RSTO	1313	3100	Hospitality Supervision		INTERNET			3									Mendoza
Contact instructor by first class day. Instructor email is pmendoza@gc.edu																	
RSTO	1325	3100	Purchasing for Hospitality Ops		INTERNET			3									Mendoza
Contact instructor by first class day. Instructor email is pmendoza@gc.edu																	
RSTO	2301	3100	Principles of Food/Bev Control		INTERNET			3									Mendoza
Contact instructor by first class day. Instructor email is pmendoza@gc.edu																	
<b>DEVELOPMENTAL EDUCATION - INTEGRATED READING AND WRITING</b>																	
INRW	0301	1000	Integrated Reading/Writing I	11:00 AM	12:20 PM	TR	N-346	3						ARR			Phillips

# SPRING 2018 SEMESTER

SUBJ	Course	Section	Course Title	CRD	Class			Laboratory			Instructor
					Start	Stop	Days	Room	Start	Stop	
INRW	0302	1010	Integrated Reading/Writing II	3	8:00 AM	9:30 AM	MW	N-346	ARR		Phillips
INRW	0302	1011	Integrated Reading/Writing II	3	9:30 AM	10:50 AM	MW	N-346	ARR		Walker
Class meets 1/16/18 - 3/9/18.											
INRW	0303	1020	Integrated Reading/Writing III	3	12:30 PM	1:50 PM	TR	N-346	ARR		Phillips
INRW	0303	1711	Integrated Reading/Writing III	3	9:30 AM	10:50 AM	MW	N-346	ARR		Walker
Class meets 3/19/18 - 5/9/18.											
INRW	0303	3100	Integrated Reading/Writing III	3	INTERNET			INTERNET			Phillips
Contact instructor by first class day. Instructor email is ephillips@gc.edu											
INRW	0311	1400	Integrated Reading/Writing III	3	11:00 AM	1:50 PM	MW	N-346	ARR		Downes
Students must also enroll in ENGL 1301-1400.											
INRW	0311	1405	Integrated Reading/Writing III	3	8:00 AM	10:50 AM	R	N-346	ARR		Walker
Students must also enroll in ENGL 1301-1405.											
<b>DEVELOPMENTAL EDUCATION - MATHEMATICS</b>											
MATH	0106	1099	Int Algebra Foundations	1	ARR			ARR			Santoyo
Class meets 1/16/18 - 3/9/18. Contact instructor by first class day. Instructor email is rsantoyo@gc.edu											
MATH	0106	1799	Int Algebra Foundations	1	ARR			ARR			Santoyo
Class meets 3/19/18 - 5/9/18. Contact instructor by first class day. Instructor email is rsantoyo@gc.edu											
MATH	0300	1012	Basic Mathematics	3	9:30 AM	10:50 AM	TR	N-240	ARR		Blackmon
MATH	0300	1013	Basic Mathematics	3	11:00 AM	12:20 PM	MW	R-252	ARR		Jones
MATH	0300	1014	Basic Mathematics	3	11:00 AM	12:20 PM	TR	R-358	ARR		Richards
MATH	0300	1099	Basic Mathematics	3	ARR			ARR			Santoyo
Class meets 1/16/18 - 3/9/18. Contact instructor by first class day. Instructor email is rsantoyo@gc.edu											

# SPRING 2018 SEMESTER

SUBJ	Course	Section	Course Title	CRD	Class			Laboratory			Instructor	
					Start	Stop	Days	Room	Start	Stop		Days
MATH	0300	1200	Basic Mathematics	3	5:30 PM	6:50 PM	TR	N-240	ARR		ARR	Blackmon
MATH	0300	1799	Basic Mathematics	3	ARR				ARR			Santoyo
Class meets 3/19/18 - 5/9/18. Contact instructor by first class day. Instructor email is rsantoyo@gc.edu												
MATH	0303	1015	Introductory Algebra	3	9:30 AM	10:50 AM	MW	R-360	ARR			Blackmon
MATH	0303	1016	Introductory Algebra	3	9:30 AM	10:50 AM	TR	R-253	ARR			Jones
MATH	0303	1017	Introductory Algebra	3	11:00 AM	12:20 PM	MW	R-360	ARR			Blackmon
MATH	0303	1018	Introductory Algebra	3	11:00 AM	12:20 PM	TR	R-360	ARR			Santoyo
MATH	0303	1019	Introductory Algebra	3	8:00 AM	9:20 AM	TR	R-360	ARR			Santoyo
MATH	0303	1099	Introductory Algebra	3	ARR				ARR			Jones
Class meets 1/16/18 - 3/9/18. Contact instructor by first class day. Instructor email is cjones@gc.edu												
MATH	0303	1200	Introductory Algebra	3	5:30 PM	6:50 PM	MW	N-240	ARR			Vance
MATH	0303	1799	Introductory Algebra	3	ARR				ARR			Jones
Class meets 3/19/18 - 5/9/18. Contact instructor by first class day. Instructor email is cjones@gc.edu												
MATH	0304	1020	Intermediate Algebra	3	12:30 PM	1:50 PM	TR	N-240	ARR			Blackmon
MATH	0304	1021	Intermediate Algebra	3	9:30 AM	10:50 AM	MW	R-252	ARR			Jones
MATH	0304	1022	Intermediate Algebra	3	11:00 AM	12:20 PM	TR	R-253	ARR			Jones
MATH	0304	1099	Intermediate Algebra	3	ARR				ARR			Blackmon
Class meets 1/16/18 - 3/9/18. Contact instructor by first class day. Instructor email is kblackmo@gc.edu												
MATH	0304	1200	Intermediate Algebra	3	5:30 PM	6:50 PM	TR	R-253	ARR			Jones
MATH	0304	1799	Intermediate Algebra	3	ARR				ARR			Blackmon
Class meets 3/19/18 - 5/9/18. Contact instructor by first class day. Instructor email is kblackmo@gc.edu												
MATH	0308	1023	Foundations of Statistics	3	11:00 AM	12:20 PM	MW	R-358	ARR			Santoyo



# SPRING 2018 SEMESTER

SUBJ	Course	Section	Course Title	CRD	Class			Laboratory			Instructor
					Start	Stop	Days	Room	Start	Stop	
MATH	0308	1200	Foundations of Statistics	3	5:30 PM	6:50 PM	MW	R-358	ARR		Santoyo
MATH	0314	1405	Intermediate Algebra	3	12:30 PM	1:50 PM	MW	R-358	ARR		Santoyo
Students must also enroll in MATH 1314-1405.											
<b>DRAMA</b>											
DRAM	1120	1000	Theater Practicum I	1	ARR						Lacy
DRAM	1121	1000	Theater Practicum II	1	ARR						Lacy
DRAM	1310	1000	Introduction to Theatre	3	12:30 PM	1:50 PM	MW	FA-214			Lacy
DRAM	1352	1000	Acting II	3	9:30 AM	10:50 AM	TR	FA-207	ARR		Lacy
DRAM	2120	1000	Theater Practicum III	1	ARR			ARR			Lacy
DRAM	2331	1000	Stagecraft II	3	11:00 AM	12:20 PM	TR	FA-207	ARR		Lacy
DRAM	2362	1600	History of Theater II	3	11:00 AM	12:20 PM	MW	FA-214			Lacy
DRAM	2362	3100	History of Theater II	3	INTERNET						Lacy
Contact instructor by first class day. Instructor email is llacy@gc.edu											
DRAM	2366	1100	Introduction to Cinema (Hybrid)	3	9:30 AM	10:50 AM	MW	FA-214	INTERNET		Lacy
Cross listed with COMM 2366-1100.											
DRAM	2366	3100	Introduction to Cinema	3	INTERNET				INTERNET		Lacy
Cross listed with COMM 2366-3100. Contact instructor by first class day. Instructor email is llacy@gc.edu											
<b>ECONOMICS</b>											
ECON	2301	1605	Principles of Macroeconomics	3	9:30 AM	10:50 AM	MW	N-303			Davison
ECON	2302	1010	Principles of Microeconomics	3	9:30 AM	10:50 AM	TR	N-303			Davison
ECON	2302	3100	Principles of Microeconomics	3	INTERNET						Davison
Contact instructor by first class day. Instructor email is ddavison@gc.edu. All exams are to be taken at Galveston College or at an off-campus testing center.											

# SPRING 2018 SEMESTER

SUBJ		Course	Section	Course Title	CRD	Class			Laboratory			Instructor		
EDUCATION						Start	Stop	Days	Room	Start	Stop	Days	Room	Instructor
EDUC	1301	3100		Intro to Teaching Profession	3	INTERNET				INTERNET				Moore
Contact instructor by first class day. Instructor email is cmoore@gc.edu														
EDUC	2301	3100		Intro to Special Populations	3	INTERNET				INTERNET				Moore
Contact instructor by first class day. Instructor email is cmoore@gc.edu														
ELECTRICAL AND ELECTRONICS TECHNOLOGY														
CETT	1307	2000		Fundamentals of Electronics	3	8:00 AM	12:50 PM	MTWRF	AT-205	8:00 AM	12:50 PM	MTWRF	AT-205	Bearden
CETT	1415	2000		Digital Applications	4	8:00 AM	12:50 PM	MTWRF	AT-205	8:00 AM	12:50 PM	MTWRF	AT-205	Bearden
ELPT	2319	2000		P L Controllers I	3	8:00 AM	12:50 PM	MTWRF	AT-205	8:00 AM	12:50 PM	MTWRF	AT-205	Bearden
INTC	1457	2000		AC/DC Motor Control	4	8:00 AM	12:50 PM	MTWRF	AT-205	8:00 AM	12:50 PM	MTWRF	AT-205	Bearden
EMERGENCY MEDICAL SERVICES														
EMSP	1160	4500		Clinical - EMT Basic	1	ARR				ARR				Ayres
EMSP	1338	3100		Intro to Advanced Practice	3	INTERNET				INTERNET				Ayres
Contact instructor by first class day. Instructor email is bayres@gc.edu														
EMSP	1355	1100		Trauma Management (Hybrid)	3	9:00 AM	9:55 AM	MW	N-245	10:00 AM	10:55 AM	MW	N-222	Ayres
EMSP	1356	1100		Patient Assess & Airway Mgmt (Hybrid)	3	11:00 AM	11:55 AM	MW	N-245	12:00 PM	12:55 PM	MW	N-222	Ayres
EMSP	1362	4500		Clinical-EMT Advanced	3	ARR				ARR				Ayres
EMSP	1501	1100		EMT - Basic (Hybrid)	5	2:00 PM	3:40 PM	MW	N-245	3:45 PM	5:20 PM	MW	N-222	Ayres
EMSP	2135	1100		Advanced Cardiac Life Support (Hybrid)	1	ARR				12:30 PM	1:20 PM	TR	N-222	Ayres
EMSP	2143	1100		Assessment Based Management (Hybrid)	1	11:35 AM	12:25 PM	TR	N-222					Ayres
EMSP	2261	4500		Clinical II - EMT Paramedic	2	ARR				ARR				Ayres

# SPRING 2018 SEMESTER

SUBJ	Course	Section	Course Title	CRD	Class			Laboratory			Instructor	
					Start	Stop	Days	Room	Start	Stop		Days
EMSP	2264	4500	Practicum I (Paramedic)	2	ARR						Ayres	
EMSP	2305	3100	EMS Operations	3	INTERNET				INTERNET		Ayres	
Contact instructor by first class day. Instructor email is bayres@gc.edu												
EMSP	2430	1100	Special Populations	4	9:00 AM	10:40 AM	TR	N-245	10:40 AM	11:30 AM	TR	N-245
<b>ENGINEERING</b>												
ENGR	1201	1205	Introduction to Engineering	2	7:00 PM	8:50 PM		N-311			Ivanova	
ENGR	1304	3100	Engineering Graphics I	3	INTERNET				INTERNET		Ivanova	
Contact instructor by first class day. Instructor email is tivanova@gc.edu												
ENGR	2105	1000	Electrical Circuits I - Lab	1	2:30 PM	5:20 PM	T	N-303			Ivanova	
ENGR	2302	1200	Engineering Mechanics-Dynamics	3	5:30 PM	6:50 PM	M	R-360			Ivanova	
ENGR	2305	1000	Electrical Circuits I	3	2:30 PM	5:20 PM	R	N-303			Ivanova	
ENGR	2308	3100	Engineering Economics	3	INTERNET						Ivanova	
Contact instructor by first class day. Instructor email is tivanova@gc.edu												
ENGR	2401	1100	Engineering Mechanics-Statics (Hybrid)	4	9:30 AM	10:50 AM	MW	N-338	INTERNET		Ivanova	
<b>ENGLISH</b>												
ENGL	1301	1000	Composition I	3	11:00 AM	12:20 PM	MW	FA-212			Davison	
ENGL	1301	1005	Composition I	3	12:30 PM	1:50 PM	TR	FA-319			Downes	
ENGL	1301	1010	Composition I	3	2:00 PM	3:20 PM	TR	R-357			Downes	
ENGL	1301	1400	Composition I	3	11:00 AM	1:50 PM	M	N-346			Downes	
Students must also enroll in INRW 0311-1400.												
ENGL	1301	1405	Composition I	3	8:00 AM	10:50 AM	T	N-346			Walker	
Students must also enroll in INRW 0311-1405.												

# SPRING 2018 SEMESTER

SUBJ	Course	Section	Course Title	CRD	Class			Laboratory			Instructor
					Start	Stop	Days	Room	Start	Stop	
ENGL	1301	3100	Composition I	3	INTERNET						Garza-Horne
Log into Canvas the first class day at <a href="https://gc.instructure.com/">https://gc.instructure.com/</a>											
ENGL	1301	3105	Composition I	3	INTERNET						Downes
Log into Canvas the first class day at <a href="https://gc.instructure.com/">https://gc.instructure.com/</a>											
ENGL	1301	3700	Composition I	3	INTERNET						Garza-Horne
Class meets 2/19/18 - 5/9/18; Log into Canvas the first class day at <a href="https://gc.instructure.com/">https://gc.instructure.com/</a>											
ENGL	1302	1600	Composition II	3	9:30 AM	10:50 AM	MW	R-357			Wallace
ENGL	1302	1610	Composition II	3	9:30 AM	10:50 AM	TR	R-358			Wallace
ENGL	1302	1615	Composition II	3	11:00 AM	12:20 PM	MW	R-357			Wallace
ENGL	1302	1620	Composition II	3	11:00 AM	12:20 PM	TR	R-357			Wallace
ENGL	1302	1625	Composition II	3	2:00 PM	3:20 PM	MW	FA-320			Berberich
ENGL	1302	1630	Composition II	3	7:00 PM	9:50 PM	T	FA-320			Berberich
ENGL	1302	3100	Composition II	3	INTERNET						Wallace
Log into Canvas the first class day at <a href="https://gc.instructure.com/">https://gc.instructure.com/</a>											
ENGL	1302	3700	Composition II	3	INTERNET						Berberich
Class meets 2/19/18 - 5/9/18; Log into Canvas the first class day at <a href="https://gc.instructure.com/">https://gc.instructure.com/</a>											
ENGL	2311	3100	Technical & Business Writing	3	INTERNET						Wallace
Contact instructor by first class day. Instructor email is <a href="mailto:swallace@gc.edu">swallace@gc.edu</a>											
ENGL	2323	1000	British Literature II	3	2:00 PM	3:20 PM	TR	FA-320			Berberich
ENGL	2328	1000	American Literature II	3	11:00 AM	12:20 PM	TR	FA-319			Downes
Topic: Gender in Pop Culture											
<b>ENVIRONMENTAL SCIENCE</b>											
ENVR	1101	3702	Environmental Science I (lab)	1	INTERNET						Hallberg
Class meets 2/19/18 - 5/9/18. Contact instructor by first class day. Instructor email is <a href="mailto:lhallber@gc.edu">lhallber@gc.edu</a>											

# SPRING 2018 SEMESTER

SUBJ	Course	Section	Course Title	CRD	Class			Laboratory			Instructor
					Start	Stop	Days	Room	Start	Stop	
ENVR	1102	3101	Environmental Science II(lab)	1	INTERNET						Salazar
	Contact instructor by first class day. Instructor email is <a href="mailto:jsalazar@gc.edu">jsalazar@gc.edu</a>										
ENVR	1102	3102	Environmental Science II(lab)	1	INTERNET						Bytautas
	Contact instructor by first class day. Instructor email is <a href="mailto:lbytautas@gc.edu">lbytautas@gc.edu</a>										
ENVR	1102	3103	Environmental Science II(lab)	1	INTERNET						Bytautas
	Contact instructor by first class day. Instructor email is <a href="mailto:lbytautas@gc.edu">lbytautas@gc.edu</a>										
ENVR	1301	1700	Environmental Science I (Hybrid)	3	5:30 PM	6:50 PM	W	R-370			Hallberg
	Class meets 2/19/18 - 5/9/18. Contact instructor by first class day. Instructor email is <a href="mailto:lhallber@gc.edu">lhallber@gc.edu</a>										
ENVR	1302	1000	Environmental Science II	3	11:00 AM	1:50 PM	T	N-303			Bytautas
ENVR	1302	3100	Environmental Science II	3	INTERNET						Salazar
	Contact instructor by first class day. Instructor email is <a href="mailto:jsalazar@gc.edu">jsalazar@gc.edu</a>										
ENVR	1302	3105	Environmental Science II	3	INTERNET						Bytautas
	Contact instructor by first class day. Instructor email is <a href="mailto:lbytautas@gc.edu">lbytautas@gc.edu</a>										
<b>GOVERNMENT</b>											
GOVT	2305	1000	Federal Government	3	8:00 AM	9:20 AM	MW	N-307			Waddell
GOVT	2305	1005	Federal Government	3	11:00 AM	12:20 PM	TR	FA-212			Gaddy
GOVT	2305	1705	Federal Government	3	7:00 PM	9:20 PM	TR	N-307			GC Faculty
	Class meets 2/19/18 - 5/9/18.										
GOVT	2305	3100	Federal Government	3	INTERNET						Durante
	Contact instructor by first class day. Instructor email is <a href="mailto:rdurante@gc.edu">rdurante@gc.edu</a>										
GOVT	2306	1010	Texas Government	3	11:00 AM	12:20 PM	MW	N-307			Waddell
GOVT	2306	1015	Texas Government	3	9:30 AM	10:50 AM	TR	N-307			Waddell
GOVT	2306	1020	Texas Government	3	11:00 AM	12:20 PM	TR	N-307			Waddell
GOVT	2306	1025	Texas Government	3	12:30 PM	1:50 PM	TR	N-307			Gaddy

# SPRING 2018 SEMESTER

SUBJ	Course	Section	Course Title	CRD	Class			Laboratory			Instructor	
					Start	Stop	Days	Room	Start	Stop		Days
GOVT	2306	1700	Texas Government	3	2:00 PM	4:20 PM	TR	N-307				Gaddy
Class meets 2/19/18 - 5/9/18.												
GOVT	2306	3110	Texas Government	3	INTERNET							Waddell
Contact instructor by first class day. Instructor email is mwaddell@gc.edu												
GOVT	2306	3115	Texas Government	3	INTERNET							Gaddy
Contact instructor by first class day. Instructor email is jgaddy@gc.edu												
<b>HEALTH INFORMATION</b>												
HPRS	1206	3100	Essentials Medical Terminology	2	INTERNET							Washington
Class meets 1/16/18 - 3/9/18. Mandatory orientation on 1/18/18 at 2pm in R-255. Purchase textbook and access code prior to orientation.												
HPRS	1206	3105	Essentials Medical Terminology	2	INTERNET							Washington
Class meets 1/16/18 - 3/9/18. Mandatory orientation on 1/18/18 at 3pm in R-255. Purchase textbook and access code prior to orientation.												
HPRS	1206	3110	Essentials Medical Terminology	2	INTERNET							Washington
Class meets 3/19/18 - 5/9/18. Mandatory orientation on 3/21/18 at 3pm in R-255. Purchase textbook and access code prior to orientation.												
HPRS	1206	3115	Essentials Medical Terminology	2	INTERNET							Washington
Class meets 3/19/18 - 5/9/18. Mandatory orientation on 3/21/18 at 4pm in R-255. Purchase textbook and access code prior to orientation.												
<b>HEATING, VENTILATION, AND AIR CONDITIONING</b>												
HART	1345	2000	Gas and Electric Heating	3	8:00 AM	12:50 PM	MTWRF	AT-206	ARR			Foster
HART	1345	2200	Gas and Electric Heating	3	5:00 PM	10:00 PM	MTWRF	AT-206	ARR			McCandless
HART	1441	2000	Residential Air Conditioning	4	8:00 AM	12:50 PM	MTWRF	AT-206	ARR			Foster
HART	1441	2200	Residential Air Conditioning	4	5:00 PM	10:00 PM	MTWRF	AT-206	ARR			McCandless
HART	2401	2000	Air Conditioning/Refrige Codes	4	8:00 AM	12:50 PM	MTWRF	AT-206	ARR			Foster
HART	2401	2200	Air Conditioning/Refrige Codes	4	5:00 PM	10:00 PM	MTWRF	AT-206	ARR			McCandless
HART	2431	2000	Advanced Electricity for HVAC	4	8:00 AM	12:50 PM	MTWRF	AT-206	ARR			Foster

# SPRING 2018 SEMESTER

SUBJ	Course	Section	Course Title	CRD	Class			Laboratory			Instructor
					Start	Stop	Days	Room	Start	Stop	
HART	2431	2200	Advanced Electricity for HVAC	4	5:00 PM	10:00 PM	MTWRF	AT-206	ARR		McCandless
<b>HISTORY</b>											
HIST	1301	1000	United States History I	3	8:00 AM	9:20 AM	MW	FA-212			Blomstedt
HIST	1301	1005	United States History I	3	2:00 PM	3:20 PM	TR	FA-212			Foret
HIST	1301	1200	United States History I	3	5:30 PM	6:50 PM	TR	N-307			Foret
HIST	1301	3100	United States History I	3	INTERNET						Blomstedt
Contact instructor by first class day. Instructor email is <a href="mailto:lblomste@gc.edu">lblomste@gc.edu</a>											
HIST	1302	1205	United States History II	3	5:30 PM	6:50 PM	MW	N-307			Janner
HIST	1302	1615	United States History II	3	12:30 PM	1:50 PM	MW	N-307			Blomstedt
HIST	1302	1620	United States History II	3	9:30 AM	10:50 AM	TR	FA-212			Blomstedt
HIST	1302	1705	United States History II	3	2:00 PM	4:20 PM	MW	N-307			Janner
Class meets 2/19/18 - 5/9/18.											
HIST	1302	3105	United States History II	3	INTERNET						Blomstedt
Contact instructor by first class day. Instructor email is <a href="mailto:lblomste@gc.edu">lblomste@gc.edu</a>											
HIST	2301	3110	Texas History	3	INTERNET						Edler
Contact instructor by first class day. Instructor email is <a href="mailto:sedler@gc.edu">sedler@gc.edu</a>											
<b>HUMANITIES</b>											
HUMA	1302	1600	Introduction to Humanities II	3	7:00 PM	9:50 PM	W	FA-319			Berberich
<b>KINESIOLOGY (See also Physical Education)</b>											
KINE	1164	3101	Intro to Physical Fitness/Spt	1	INTERNET						Breitbach
Contact instructor by first class day. Instructor email is <a href="mailto:cbreitba@gc.edu">cbreitba@gc.edu</a>											
KINE	1301	1140	Introduction to Kinesiology (Hybrid)	3	11:00 AM	12:20 PM	T	FA-215			Breitbach

# SPRING 2018 SEMESTER

SUBJ Course Section Course Title				CRD	Class			Laboratory			Instructor		
SUBJ	Course	Section	Course Title	CRD	Start	Stop	Days	Room	Start	Stop	Days	Room	Instructor
KINE	1301	3110	Introduction to Kinesiology	3	INTERNET								Breitbach
Contact instructor by first class day. Instructor email is cbreitba@gc.edu													
KINE	1304	1720	Personal/Community/Wellness	3	7:00 PM	9:20 PM	TR	FA-321					GC Faculty
Class meets 2/19/18 - 5/9/18.													
KINE	1304.	3115	Personal/Community/Wellness/I	3	INTERNET								Breitbach
Contact instructor by first class day. Instructor email is cbreitba@gc.edu													
KINE	1338	1100	Concepts of Physical Fitness	3	9:30 AM	10:50 AM	M	FA-215					Breitbach
KINE	1346	3125	Drug Use and Abuse	3	INTERNET								Breitbach
Contact instructor by first class day. Instructor email is cbreitba@gc.edu													
KINE	2356	1100	Care/Prevention Athlete Injury (Hybrid)	3	11:00 AM	12:20 PM	M	FA-215					Breitbach
<b>LAW ENFORCEMENT ACADEMY</b>													
CJLE	1518	1200	Basic Peace Officer III	5	6:30 PM	10:30 PM	MTWR	N-337	ARR				Pyle
Class meets 1/8/18 - 3/2/18.													
CJLE	1524	1200	Basic Peace Officer IV	5	6:30 PM	10:30 PM	MTWR	N-337	ARR				Pyle
Class meets 3/5/18 - 5/15/18.													
PHED	2100	1200	Fitness Train: Law Enforce III	1	6:30 PM	10:30 PM	F	H-100	ARR				Pyle
Class meets 1/8/18 - 3/2/18.													
PHED	2101	1200	Fitness Train: Law Enforce IV	1	6:30 PM	10:30 PM	F	H-100	ARR				Pyle
Class meets 3/5/18 - 5/15/18.													
<b>LEARNING FRAMEWORK</b>													
EDUC	1300	1730	Learning Framework	3	9:30 AM	10:50 AM	MW	R-251					Walker
Class meets 2/19/18 - 5/9/18.													
EDUC	1300	1010	Learning Framework	3	12:30 PM	1:50 PM	TR	FA-209					Culver



# SPRING 2018 SEMESTER

SUBJ	Course	Section	Course Title	CRD	Class			Laboratory						
					Start	Stop	Days	Room	Start	Stop	Days	Room	Instructor	
EDUC	1300	1200	Learning Framework	3	5:30 PM	6:50 PM	MW	FA-321					Phillips	
EDUC	1300	3100	Learning Framework	3	INTERNET									Walker
Contact instructor by first class day. Instructor email is mwalker@gc.edu														
PSYC	1300	1730	Learning Framework	3	9:30 AM	10:50 AM	MW	R-251						Walker
Class meets 2/19/18 - 5/9/18.														
PSYC	1300	1010	Learning Framework	3	12:30 PM	1:50 PM	TR	FA-209						Culver
PSYC	1300	1200	Learning Framework	3	5:30 PM	6:50 PM	MW	FA-321						Phillips
PSYC	1300	3100	Learning Framework	3	INTERNET									Walker
Contact instructor by first class day. Instructor email is mwalker@gc.edu														
<b>MAGNETIC RESONANCE IMAGING</b>														
MRIT	1170	3100	MRI Safety	1	INTERNET									Mai
Contact instructor by first class day. Instructor email is hmai@gc.edu														
MRIT	1191	3100	Special Topics in MRI	1	INTERNET									Mai
Contact instructor by first class day. Instructor email is hmai@gc.edu														
MRIT	2330	3100	Principles of MRI	3	INTERNET									Mai
Contact instructor by first class day. Instructor email is hmai@gc.edu														
MRIT	2334	3100	MRI Equipment and Methodology	3	INTERNET									Mai
Contact instructor by first class day. Instructor email is hmai@gc.edu														
MRIT	2355	3100	MRI Physics	3	INTERNET									Mai
Contact instructor by first class day. Instructor email is hmai@gc.edu														
MRIT	2560	4500	Clinical I	5	ARR									Mai
MRIT	2561	4500	Clinical II	5	ARR									Mai

# SPRING 2018 SEMESTER

SUBJ		Course	Section	Course Title	CRD	Class			Laboratory			Instructor		
MATH		MATHEMATICS				Start	Stop	Days	Room	Start	Stop	Days	Room	
MATH	1314	1600	College Algebra	3	11:30 AM	12:50 PM	MTWR	N-311	11:00 AM	11:25 AM	MTWR	N-311	Khoury	
Class meets 1/16/18 - 3/9/18. This section is intended for students enrolling in MATH 2312.1700.														
MATH	1314	1100	College Algebra (Hybrid)	3	8:00 AM	9:20 AM	MW	R-357	ARR				Rimar	
MATH	1314	1110	College Algebra (Hybrid)	3	9:30 AM	10:50 AM	TR	R-357	ARR				Leuchtag	
MATH	1314	1300	College Algebra (Hybrid)	3	5:30 PM	6:50 PM	MW	N-311	ARR				Warren	
MATH	1314	1405	College Algebra (Hybrid)	3	12:30 PM	1:50 PM	TR	R-357	ARR				Warren	
Students must also enroll in MATH 0314-1405.														
MATH	1314	3100	College Algebra	3	INTERNET				INTERNET				Warren	
Contact instructor by first class day. Instructor email is jwarren@gc.edu														
MATH	1324	1100	Math for Bus/Soc.Science Hybrid)	3	8:00 AM	9:20 AM	TR	R-360	ARR				Warren	
Contact instructor by first class day. Instructor email is jwarren@gc.edu														
MATH	1324	3100	Math for Bus/Soc.Science	3	INTERNET				INTERNET				Warren	
All tests must be taken face-to-face with instructor. Contact instructor by first class day. Instructor email is jwarren@gc.edu														
MATH	1325	1100	Calculus for Bus/Soc Sciences	3	8:00 AM	9:20 AM	TR	R-357	ARR				Rimar	
MATH	1325	1300	Calculus for Bus/Soc Sciences (Hybrid)	3	5:30 PM	6:50 PM	MW	R-357	ARR				Rimar	
MATH	1332	3100	Contemporary Math I	3	INTERNET				INTERNET				Kelley	
All tests must be taken face-to-face with instructor. Contact instructor by first class day. Instructor email is kkelley@gc.edu														
MATH	1342	1200	Elementary Statistical Methods	3	5:30 PM	6:50 PM	TR	N-311	5:00 PM	5:25 PM	TR	N-311	Khoury	
MATH	1342	3100	Elementary Statistical Methods	3	INTERNET				INTERNET				Khoury	
Contact instructor by first class day. Instructor email is fkhoury@gc.edu														

# SPRING 2018 SEMESTER

SUBJ	Course	Section	Course Title	CRD	Class			Laboratory			Instructor	
					Start	Stop	Days	Room	Start	Stop		Days
MATH	1350	3100	Math for Teachers I	3	INTERNET			INTERNET			Warren	
Contact instructor by first class day. Instructor email is jwarren@gc.edu												
MATH	1351	3100	Math for Teachers II	3	INTERNET			INTERNET			Warren	
Contact instructor by first class day. Instructor email is jwarren@gc.edu												
MATH	2305	1100	Discrete Mathematics	3	INTERNET			INTERNET			Khoury	
MATH	2312	1000	Precalculus Math	3	1:00 PM	2:20 PM	MW	N-311	2:30 PM	3:50 PM	MW	N-311
MATH	2312	1700	Precalculus Math	3	11:30 AM	12:50 PM	MTWR	N-311	11:00 AM	11:20 AM	MTWR	N-311
Class meets 3/19/18 - 5/9/18.												
MATH	2320	1100	Differential Equations (Hybrid)	3	1:00 PM	2:20 PM	TR	N-311	ARR			
MATH	2321	1100	Diff Equation & Linear Algebra (Hybrid)	3	ARR				ARR			
MATH	2413	1000	Calculus I	4	8:00 AM	9:20 AM	MW	N-311	9:30 AM	10:50 AM	MW	N-311
MATH	2414	1200	Calculus II	4	7:00 PM	8:20 PM	MW	R-357	8:30 PM	9:50 PM	MW	R-357
MATH	2415	1000	Calculus III	4	8:00 AM	9:20 AM	TR	N-311	9:30 AM	10:50 AM	TR	N-311
<b>MEDICAL ADMINISTRATION</b>												
HITT	1305	2300	Medical Terminology I (Hybrid)	3	5:30 PM	6:50 PM	T	AT-300				Swartz
HITT	1341	2300	Coding & Classification System (Hybrid)	3	5:30 PM	9:20 PM	M	AT-300	ARR			Swartz
Class meets 1/16/18 - 3/9/18.												
HITT	1380	4600	Hlth Info/Med Records Coop Edu	3	ARR							Swartz
HITT	2335	2300	Coding Reimburse Methodologies (Hybrid)	3	5:30 PM	9:20 PM	W	AT-300	ARR			Swartz
Class meets 1/16/18 - 3/9/18.												

# SPRING 2018 SEMESTER

SUBJ	Course	Section	Course Title	CRD	Class			Laboratory			Instructor	
					Start	Stop	Days	Room	Start	Stop		Days
HITT	2340	2300	Adv. Medical Billing & Rmbrsmnt (Hybrid)	3	7:30 PM	9:20 PM	MW	AT-300			Swartz	
Class meets 3/19/18 - 5/9/18.												
HITT	2346	2300	Advanced Medical Coding (Hybrid)	3	5:30 PM	7:20 PM	MW	AT-300	ARR		Swartz	
Class meets 3/19/18 - 5/9/18.												
MDCA	1309	2300	A&P for Medical Assistants (Hybrid)	3	7:00 PM	8:20 PM	T	AT-300			Swartz	
POFM	1327	3100	Medical Insurance	3	INTERNET						Becker	
Contact instructor by first class day. Instructor email is kbecker@gc.edu												
<b>MUSIC</b>												
MUAP	1199	1650	App Music-Secondary Instrument	1	ARR				ARR		Kates-Hammond	
Contact instructor by first class day. Instructor email is kates@gc.edu												
MUAP	1285	1602	Voice	2	ARR				ARR		Kates-Hammond	
MUAP	1299	1655	App Music Principal Instrument	2	ARR				ARR		Kates-Hammond	
Contact instructor by first class day. Instructor email is kates@gc.edu												
MUAP	1299	1660	App Music Principal Instrument	2	ARR				ARR		Kates-Hammond	
Class meets 2/19/18 - 5/9/18. Contact instructor by first class day. Instructor email is kates@gc.edu												
MUEN	1141	1200	College Choir	1	7:00 PM	9:00 PM	M	FA-207			Gilbert	
MUSI	1192	1205	Guitar Class I	1	6:00 PM	6:55 PM	R	FA-214		ARR	GC Faculty	
MUSI	1306	1210	Music Appreciation	3	7:00 PM	9:50 PM	M	FA-210			Kates-Hammond	
MUSI	1306	3100	Music Appreciation	3	INTERNET						Kates-Hammond	
Contact instructor by first class day. Instructor email is kates@gc.edu												
MUSI	1306	3700	Music Appreciation	3	INTERNET						Kates-Hammond	
Class meets 2/19/18 - 5/9/18. Contact instructor by first class day. Instructor email is kates@gc.edu												

# SPRING 2018 SEMESTER

SUBJ	Course	Section	Course Title	CRD	Class			Laboratory			Instructor
					Start	Stop	Days	Room	Start	Stop	
MUSI	1310	3100	American Music	3	INTERNET						Kates-Hammond
Contact instructor by first class day. Instructor email is ckates@gc.edu											
<b>NUCLEAR MEDICINE</b>											
NMTT	1162	4500	Clinical Nuclear Medical Tech	1	ARR						Montz
NMTT	1203	1100	Radiation Biology and Safety (Hybrid)	2	1:30 PM	3:25 PM	T	N-218			Montz
NMTT	1309	1100	NMT Instrumentation (Hybrid)	3	9:30 AM	12:25 PM	T	N-218	ARR		Montz
NMTT	2201	1100	Radiochemistry & Radiopharmacy (Hybrid)	2	9:30 AM	11:25 AM	R	N-218	ARR		Montz
NMTT	2235	1100	Nuclear Medicine Tech Seminar (Hybrid)	2	9:00 AM	10:55 AM	F	N-218	ARR		Montz
NMTT	2467	4500	Practicum III - NMT	4	ARR						Montz
<b>NURSING</b>											
RNSG	1144	1000	Nursing Skills II	1	9:00 AM	11:50 AM	R	M-220			Fields
RNSG	1144	1005	Nursing Skills II	1	9:00 AM	11:50 AM	R	M-220			Fields
RNSG	1215	1000	Health Assessment	2	1:00 PM	1:50 PM	R	R-250	2:00 PM	3:50 PM	Perry
RNSG	1215	1100	Health Assessment (Hybrid)	2	1:00 PM	1:50 PM	T	R-250	2:00 PM	3:50 PM	Fields
Class will meet 1/18, 2/14, 3/7, 4/4 and 5/2.											
RNSG	1301	1000	Pharmacology	3	1:00 PM	3:50 PM	W	R-252			Harbeson
RNSG	1301	3100	Pharmacology	3	INTERNET						Washington
Mandatory orientation on 1/16/18 at 1pm in R-255. Purchase textbook and access code from GC Bookstore prior to orientation.											
RNSG	1301	3101	Pharmacology	3	INTERNET						Washington
Mandatory orientation on 1/16/18 at 4pm in R-255. Purchase textbook and access code from GC Bookstore prior to orientation.											
RNSG	1360	4500	Clinical (Common Concepts)	3	ARR						Hembd
RNSG	1441	1000	Common Concepts/Adult Health	4	9:00 AM	11:50 AM	W	R-250	8:00 AM	9:55 AM	Hembd

# SPRING 2018 SEMESTER

SUBJ	Course	Section	Course Title	CRD	Class			Laboratory			Instructor			
					Start	Stop	Days	Room	Start	Stop		Days	Room	
RNSG	1441	1000	Common Concepts/Adult Health	4	9:00 AM	11:50 AM	W	R-250	10:00 AM	11:55 AM	R	R-257	Hembd	
RNSG	1441	1005	Common Concepts/Adult Health	4	9:00 AM	11:50 AM	W	R-250	8:00 AM	9:55 AM	R	R-250	Hembd	
RNSG	1441	1005	Common Concepts/Adult Health	4	9:00 AM	11:50 AM	W	R-250	1:00 PM	2:55 PM	R	R-257	Hembd	
RNSG	1443	1010	Complex Concepts/Adult Health	4	9:00 AM	12:00 PM	W	FA-207	1:00 PM	2:50 PM	W	FA-207	Fields	
RNSG	2262	4500	Clinical (Complex Concepts)	2	ARR								Fields	
<b>PHILOSOPHY</b>														
PHIL	1301	1310	Introduction to Philosophy (Hybrid)	3	7:00 PM	8:20 PM	R	FA-209					Lariviere	
PHIL	1301	3100	Introduction to Philosophy	3	INTERNET								Lariviere	
Contact instructor by first class day. Instructor email is dlarivie@gc.edu														
<b>PHYSICAL EDUCATION (See also Kinesiology)</b>														
PHED	1137	1015	Aerobics: Running/Jogging I	1	8:00 AM	9:20 AM	TR	H-106					GC Faculty	
PHED	1138	1020	Aerobics: Running/Jogging II	1	8:00 AM	9:20 AM	TR	H-106					GC Faculty	
PHED	1144	1025	Strength and Conditioning	1	9:30 AM	10:50 AM	TR	H-200					Breitbach	
PHED	1144	1209	Strength and Conditioning	1	5:30 PM	6:50 PM	MW	H-106					Breitbach	
PHED	1148	1000	Weight Training I	1	12:30 PM	1:50 PM	TR	H-106					Breitbach	
PHED	1149	1000	Weight Training II	1	12:30 PM	1:50 PM	MW	H-106					Breitbach	
<b>PHYSICS</b>														
PHYS	1401	1300	College Physics I (Hybrid)	4	ARR					5:30 PM	8:20 PM	M	N-303	Gebreselasie
Contact instructor by first class day. Instructor email is dgebrese@gc.edu														
PHYS	1401	1305	College Physics I (Hybrid)	4	5:30 PM	8:20 PM	W	N-303					Gebreselasie	
Contact instructor by first class day. Instructor email is dgebrese@gc.edu														

# SPRING 2018 SEMESTER

SUBJ	Course	Section	Course Title	CRD	Class			Laboratory			Instructor		
					Start	Stop	Days	Room	Start	Stop		Days	Room
PHYS	1402	1305	College Physics II (Hybrid)	4	5:30 PM	8:20 PM	T	N-303	ARR		Gebreselasie		
Contact instructor by first class day. Instructor email is dgebresie@gc.edu													
PHYS	1402	1310	College Physics II (Hybrid)	4	5:30 PM	8:20 PM	R	N-303	ARR		Gebreselasie		
Contact instructor by first class day. Instructor email is dgebresie@gc.edu													
PHYS	2426	1005	University Physics II	4	2:00 PM	4:50 PM	M	N-303	2:00 PM	4:50 PM	W	N-303	
<b>PSYCHOLOGY</b>													
PSYC	2301	1025	General Psychology	3	8:00 AM	9:20 AM	TR	N-337				Perez	
PSYC	2301	1210	General Psychology	3	5:50 PM	6:50 PM	MW	FA-320				Goomas	
PSYC	2301	1610	General Psychology	3	11:00 AM	12:20 PM	MW	N-337				Tapp	
PSYC	2301	3110	General Psychology	3	INTERNET								Tapp
Contact instructor by first class day. Instructor email is etapp@gc.edu													
PSYC	2301	3700	General Psychology	3	INTERNET								Little
Class meets 2/19/18 - 5/9/18. Contact instructor by first class day. Instructor email is dlittle@gc.edu													
PSYC	2314	1030	Life-Span Growth & Development	3	11:00 AM	12:20 PM	TR	N-337				Tapp	
PSYC	2314	1210	Life-Span Growth & Development	3	5:30 PM	6:50 PM	TR	N-245				Tapp	
PSYC	2317	3115	Statistical Methods in Psych	3	INTERNET							Little	
Contact instructor by first class day. Instructor email is dlittle@gc.edu													
<b>RADIATION THERAPY</b>													
RADT	1191	1100	Special Topics: Trends (Hybrid)	1	12:00 PM	12:55 PM	W	N-227				Callahan	
RADT	1291	1100	Special Topics: (RT Seminar) (Hybrid)	2	10:00 AM	11:55 AM	F	N-227				Callahan	
RADT	1344	1100	Instrumentation/Methodologies (Hybrid)	3	8:00 AM	10:55 AM	M	N-227				Callahan	
RADT	2401	1100	Oncology I (Hybrid)	4	11:00 AM	1:55 PM	M	N-227				Callahan	

# SPRING 2018 SEMESTER

SUBJ	Course	Section	Course Title	CRD	Class			Laboratory			Instructor		
					Start	Stop	Days	Room	Start	Stop		Days	Room
RADT	2407	1100	Dosimetry I (Hybrid)	4	8:00 AM	11:55 AM	W	N-227	1:00 PM	1:50 PM	W	N-227	Callahan
RADT	2466	4500	Practicum III (AAS)	4	ARR								Callahan
<b>RADIOGRAPHY</b>													
RADR	1250	1000	Radiographic Image Evaluation	2	9:00 AM	11:50 AM	W	N-235	12:00 PM	1:00 PM	W	N-221	Martinez
RADR	1267	4500	Practicum II	2	ARR								Martinez
RADR	1313	1000	Prin of Radiographic Imaging I	3	9:00 AM	11:55 AM	T	N-235	ARR				Fink
RADR	1367	4500	Practicum III	3	ARR								Fink
RADR	2333	1000	Advanced Medical Imaging	3	1:00 PM	3:55 PM	R	N-235					Fink
RADR	2335	1000	Radiologic Technology Seminar	3	9:00 AM	11:55 AM	R	N-235					Fink
RADR	2340	3100	Sectional Anatomy/Med Imaging	3	INTERNET								Koebele
Contact instructor by first class day. Instructor email is mkoebele@gc.edu													
RADR	2340	3105	Sectional Anatomy/Med Imaging	3	INTERNET								Koebele
Contact instructor by first class day. Instructor email is mkoebele@gc.edu													
RADR	2401	1000	Intermediate Radiographic Proc	4	9:00 AM	11:55 AM	M	N-235	1:00 PM	3:55 PM	MT	N-221	Martinez
<b>SOCIOLOGY</b>													
SOCI	1301	1000	Introductory Sociology	3	9:30 AM	10:50 AM	TR	FA-211					Hoskins
SOCI	1301	1010	Introductory Sociology	3	11:00 AM	12:20 PM	MW	FA-211					Nelson
SOCI	1301	3700	Introductory Sociology	3	INTERNET								Tapp
Class meets 2/19/18 - 5/9/18. Contact instructor by first class day. Instructor email is etapp@gc.edu													
SOCI	1306	1015	Social Problems	3	9:30 AM	10:50 AM	MW	FA-211					Nelson
SOCI	2301	1001	Marriage and the Family	3	8:00 AM	9:20 AM	TR	FA-211					Hoskins
SOCI	2319	3105	Multicultural Studies	3	INTERNET								Tapp
Contact instructor by first class day. Instructor email is etapp@gc.edu													



# SPRING 2018 SEMESTER

SUBJ		Course	Section	Course Title	CRD	Class			Laboratory			Instructor		
SPANISH						Start	Stop	Days	Room	Start	Stop	Days	Room	
SPAN		1411	3100	Beginning Spanish I	4	INTERNET								Flint
		Contact instructor by first class day. Instructor email is iflint@gc.edu												
SPAN		1412	3100	Beginning Spanish II	4	INTERNET								Flint
		Contact instructor by first class day. Instructor email is iflint@gc.edu												
<b>SPEECH</b>														
SPCH	1311	1000		Intro to Speech Communication	3	11:00 AM	12:20 PM	TR	FA-210					Boullion
SPCH	1315	1000		Public Speaking	3	9:30 AM	10:50 AM	MW	FA-320					Davison
SPCH	1315	1715		Public Speaking	3	7:00 PM	9:20 PM	MW	FA-320					GC Faculty
		Class meets 2/19/18 - 5/9/18.												
SPCH	1315	3100		Public Speaking	3	INTERNET								Davison
		Log into Canvas the first class day at <a href="https://gc.instructure.com/Email/jdavison@gc.edu">https://gc.instructure.com/Email/jdavison@gc.edu</a> with questions.												
SPCH	1318	1000		Interpersonal Communication	3	8:00 AM	9:00 AM	TR	FA-320					Davison
SPCH	1321	3100		Business and Professional Comm	3	INTERNET								Boullion
<b>SURGICAL TECHNOLOGY</b>														
HITT	1305	1100		Medical Terminology I (Hybrid)	3	11:00 AM	12:30 PM	R	N-228					Sempe
HPRS	1201	1100		Intro to Health Professions (Hybrid)	2	1:00 PM	2:30 PM	R	N-228					Sempe
HPRS	1201	3100		Intro to Health Professions	2	INTERNET								Sempe
		Contact instructor by first class day. Instructor email is asempe@gc.edu												
SCIT	1307	1100		Applied Human A & P I (Hybrid)	3	3:00 PM	4:30 PM	R	N-228					Sempe
SRGT	1542	1100		Surgical Procedures II (Hybrid)	5	10:00 AM	12:00 PM	T	N-228	1:00 PM	4:00 PM	T	N-228	Sempe
SRGT	1562	4500		Clinical III	5	MWF			ARR					Sempe
SRGT	2130	1100		Professional Readiness (Hybrid)	1	9:00 AM	10:30 AM	R	N-228					Sempe

# SPRING 2018 SEMESTER

SUBJ	Course	Section	Course Title	CRD	Class			Laboratory			Instructor		
					Start	Stop	Days	Room	Start	Stop		Days	Room
<b>VOCATIONAL NURSING</b>													
VNSG	1162	4500	Clinical (Maternal-Neonatal)	1	ARR						Britton		
VNSG	1162	4501	Clinical (Maternal-Neonatal)	1	ARR						Britton		
VNSG	1162	4502	Clinical (Maternal-Neonatal)	1	ARR						Britton		
VNSG	1191	1000	Specialty Topic VN NCLEX Prep	1	1:30 PM	3:25 PM	M	R-255			Britton		
VNSG	1227	1000	Essentials of Medication Admin	2	1:30 PM	3:20 PM	T	R-251	3:30 PM	4:20 PM	Britton		
VNSG	1231	1000	Pharmacology	2	2:00 PM	4:30 PM	R	R-252	ARR		Fields		
VNSG	1320	3100	A&P for Allied Health	3	INTERNET				INTERNET		Washington		
Mandatory orientation on 1/17/18 at 2pm in R-255. Purchase textbook and access code from GC Bookstore prior to orientation.													
VNSG	2262	4500	Clinical (Medical-Surg II)	2	ARR						Britton		
Class meets 2/26/18 - 5/9/18.													
VNSG	2410	1000	Nursing Health & Illness III	4	9:00 AM	12:25 PM	TR	R-251	ARR		Britton		
<b>WELDING</b>													
WLDG	1313	2200	Intro to Blueprint Reading	3	5:30 PM	10:30 PM	MTWRF	AT-213	5:30 PM	10:30 PM	MTWRF	AT-213	GC Faculty
WLDG	1317	2000	Intro to Layout & Fabrication	3	8:00 AM	12:50 PM	MTWRF	AT-203	8:00 AM	12:50 PM	MTWRF	AT-203	Love
WLDG	1407	2200	Intro to Welding Multi Process	4	5:30 PM	10:30 PM	MTWRF	AT-213	5:30 PM	10:30 PM	MTWRF	AT-213	GC Faculty
WLDG	1428	2200	Intro-Shielded Metal Arc Weld	4	5:30 PM	10:30 PM	MTWRF	AT-213	5:30 PM	10:30 PM	MTWRF	AT-213	GC Faculty
WLDG	1434	2200	Intro-Gas Tungsten Arc Welding	4	5:30 PM	10:30 PM	MTWRF	AT-213	5:30 PM	10:30 PM	MTWRF	AT-213	GC Faculty
WLDG	1435	2000	Intro to Pipe Welding	4	8:00 AM	12:50 PM	MTWRF	AT-203	8:00 AM	12:50 PM	MTWRF	AT-203	Love
WLDG	2413	2000	Intermediate Weld Multi Prcss	4	8:00 AM	12:50 PM	MTWRF	AT-203	8:00 AM	12:50 PM	MTWRF	AT-203	Love
WLDG	2443	2000	Adv Shielded Metal Arc Welding	4	8:00 AM	12:50 PM	MTWRF	AT-203	8:00 AM	12:50 PM	MTWRF	AT-203	Love

# SECOND START - SPRING

SUBJ	Course	Section	Course Title	CRD	Class			Laboratory			Instructor	
					Start	Stop	Days	Room	Start	Stop		Days
<b>Second Start Classes begin 2/19/18 and end 5/9/2018</b>												
<b>ARTS</b>												
ARTS	1301	1710	Art Appreciation	3	7:00 PM	9:20 PM	FA-319					GC Faculty
Class meets 2/19/18 - 5/9/18.												
<b>COMPUTER SCIENCE</b>												
BCIS	1305	3700	Business Computer Applications	3	INTERNET				INTERNET			Way
Class meets 2/19/18 - 5/9/18. Contact instructor by first class day. Instructor email is wway@gc.edu												
<b>DEVELOPMENTAL EDUCATION - INTEGRATED READING AND WRITING</b>												
INRW	0303	1725	Integrated Reading/Writing III	3	7:00 PM	9:20 PM	TR	N-346				Walker
Class meets 3/19/18 - 5/9/18.												
<b>ENGLISH</b>												
ENGL	1301	3700	Composition I	3	INTERNET							Garza-Horne
Class meets 2/19/18 - 5/9/18; Log into Canvas the first class day at <a href="https://gc.instructure.com/">https://gc.instructure.com/</a>												
ENGL	1302	3700	Composition II	3	INTERNET							Berberich
Class meets 2/19/18 - 5/9/18; Log into Canvas the first class day at <a href="https://gc.instructure.com/">https://gc.instructure.com/</a>												
<b>ENVIRONMENTAL SCIENCE</b>												
ENVR	1101	3702	Environmental Science I (lab)	1	INTERNET							Hallberg
Class meets 2/19/18 - 5/9/18. Contact instructor by first class day. Instructor email is lhallber@gc.edu												
ENVR	1301	1700	Environmental Science I	3	5:30 PM	6:50 PM	W	R-370				Hallberg
Class meets 2/19/18 - 5/9/18. Contact instructor by first class day. Instructor email is lhallber@gc.edu												
<b>GOVERNMENT</b>												
GOVT	2305	1705	Federal Government	3	7:00 PM	21:20	TR	N-307				GC Faculty
Class meets 2/19/18 - 5/9/18.												

# SECOND START - SPRING

SUBJ	Course	Section	Course Title	CRD	Class			Laboratory			Instructor	
					Start	Stop	Days	Room	Start	Stop		Days
GOVT	2306	1700	Texas Government	3	2:00 PM	4:20 PM	TR	N-307				Gaddy
Class meets 2/19/18 - 5/9/18.												
<b>HISTORY</b>												
HIST	1302	1705	United States History II	3	2:00 PM	4:20 PM	MW	N-307				Janner
Class meets 2/19/18 - 5/9/18.												
<b>LEARNING FRAMEWORK</b>												
EDUC	1300	1730	Learning Framework	3	9:30 AM	10:50 AM	MW	R-251				Walker
Class meets 2/19/18 - 5/9/18.												
PSYC	1300	1730	Learning Framework	3	9:30 AM	10:50 AM	MW	R-251				Walker
Class meets 2/19/18 - 5/9/18.												
<b>KINESIOLOGY</b>												
KINE	1304	1720	Personal/Community/Wellness	3	7:00 PM	9:20 PM	TR	FA-321				GC Faculty
Class meets 2/19/18 - 5/9/18.												
<b>MUSIC</b>												
MUAP	1299	1660	App Music Principal Instrument	2	ARR				ARR			Kates-Hammond
Class meets 2/19/18 - 5/9/18. Contact instructor by first class day. Instructor email is ckates@gc.edu												
MUSI	1306	3700	Music Appreciation	3	INTERNET							Kates-Hammond
Class meets 2/19/18 - 5/9/18. Contact instructor by first class day. Instructor email is ckates@gc.edu												
<b>PSYCHOLOGY</b>												
PSYC	2301	3700	General Psychology	3	INTERNET							Little
Class meets 2/19/18 - 5/9/18. Contact instructor by first class day. Instructor email is dlittle@gc.edu												
<b>SOCIOLOGY</b>												
SOCI	1301	3700	Introductory Sociology	3	INTERNET							Tapp
Class meets 2/19/18 - 5/9/18. Contact instructor by first class day. Instructor email is etapp@gc.edu												

# SECOND START - SPRING

SUBJ	Course	Section	Course Title	CRD	Class			Laboratory			Instructor
					Start	Stop	Days	Room	Start	Stop	
<b>SPEECH</b>											
SPCH	1315	1715	Public Speaking	3	7:00 PM	9:20 PM	FA-320				GC Faculty
Class meets 2/19/18 - 5/9/18.											

## Spring 2018 Second Start Classes Begin Monday, February 19, 2018

### REFUND POLICY (Credit Courses Only)

Under the rules promulgated by the Texas Higher Education Coordinating Board, Galveston College will refund tuition and applicable fees for withdrawals and dropped classes as scheduled below:

100% prior to February 19, 2018

70% prior to 5:00pm on March 1, 2018

25% prior to 5:00pm on March 6, 2018

None after 5:00pm on March 6, 2018

**Galveston College Approved Course Fees  
2017 - 2018  
(Effective: April 1, 2017)**

Dept	Course	Course Title	Lab	Health Insurance	Misc
<b>ACCOUNTING</b>					
ACCT	2301	Financial Accounting	24.00		
ACCT	2302	Managerial Accounting	24.00		
<b>ART</b>					
ARTS	1311	Design I	24.00		
ARTS	1312	Design II 3-Dimensional	24.00		
ARTS	1316	Drawing I	24.00		
ARTS	1317	Drawing II	24.00		
ARTS	2313	Design Communications I	24.00		
ARTS	2316	Painting I	24.00		
ARTS	2317	Painting II	24.00		
ARTS	2326	Sculpture I	24.00		
ARTS	2327	Sculpture II	24.00		
ARTS	2346	Ceramics I	24.00		
ARTS	2347	Ceramics II	24.00		
ARTS	2356	Photography I	24.00		
ARTS	2357	Photography II	24.00		
<b>BIOLOGY</b>					
BIOL	1406	General Biology I	24.00		
BIOL	1407	General Biology II	24.00		
BIOL	2401	Anatomy and Physiology I	24.00		
BIOL	2402	Anatomy and Physiology II	24.00		
BIOL	2421	Microbiology for Science Majors	24.00		
<b>BUSINESS COMPUTER INFORMATION SYSTEMS</b>					
BCIS	1305	Bus Computer Applications	24.00		
<b>CHEMISTRY</b>					
CHEM	1405	Introductory Chemistry I	24.00		
CHEM	1411	General Chemistry I	24.00		
CHEM	1412	General Chemistry II	24.00		
CHEM	2423	Organic Chemistry I	24.00		
CHEM	2425	Organic Chemistry II	24.00		
<b>CRIMINAL JUSTICE</b>					
CJLE	1506	Basic Peace Officer I	24.00		125.00
CJLE	1512	Basic Peace Officer II	24.00		125.00
CJLE	1518	Basic Peace Officer III	24.00		125.00
CJLE	1524	Basic Peace Officer IV	24.00		125.00
<b>COMPUTED TOMOGRAPHY (CT)</b>					
CTMT	2460	Clinical I (Computed Tomography)		100.00	13.00 48.00

## COMPUTER SCIENCE

COSC 1301	Introduction to Computing	24.00
COSC 1336	Programming Fundamentals I	24.00
COSC 1337	Programming Fundamentals II	24.00
COSC 2325	Computer Organization	24.00
COSC 2336	Programming Fundamentals III	24.00

## COSMETOLOGY

CSME 1354	Artistry of Hair Design	24.00	18.00	
CSME 1355	Artistry of Hair Design II	24.00	27.00	
CSME 1401	Orientation to Cosmetology	24.00	105.00	
CSME 1410	Introduction to Haircutting and Related Theory	24.00	13.00	24.00
CSME 1435	Orientation of the Instruction of Cosmetology	24.00	13.00	
CSME 1453	Chemical Reformation and Related Theory	24.00	13.00	27.00
CSME 1534	Cosmetology Instructor I	24.00		
CSME 1547	Principles of Skin Care/Facials and Related Theory	24.00	13.00	125.00
CSME 2310	Advanced Haircutting and Related Theory	24.00	13.00	24.00
CSME 2343	Salon Development	24.00	24.00	
CSME 2414	Cosmetology Instructor II	24.00	13.00	
CSME 2439	Advanced Hair Design	24.00		
CSME 2441	Preparation for the State Licensing Examination	24.00		
CSME 2445	Instructional Theory and Clinic Operations	24.00	13.00	
CSME 2501	The Principles of Hair Coloring and Related Theory	24.00	13.00	50.00
CSME 2544	Cosmetology Instructor IV	24.00		
CSME 2549	Cosmetology Instructor III	24.00		

## CULINARY ARTS

CHEF 1301	Basic Food Preparation	24.00	24.00
CHEF 1302	Principles of Healthy Cuisine	24.00	24.00
CHEF 1310	Garde Manger	24.00	24.00
CHEF 1341	American Regional Cuisine	24.00	24.00
CHEF 1345	International Cuisine	24.00	24.00
CHEF 2302	Saucier	24.00	24.00
PSTR 1301	Fundamentals of Baking	24.00	24.00

## DEVELOPMENTAL EDUCATION - INTEGRATED READING AND WRITING

INRW 0301	Basic Integrated Reading and Writing	24.00
INRW 0302	Intermediate Integrated Reading and Writing	24.00

INRW 0303 Advanced Integrated Reading and Writing 24.00

### **DEVELOPMENTAL EDUCATION - MATHEMATICS**

MATH 0106 Intermediate Algebra Foundations 24.00

MATH 0300 Basic Mathematics 24.00

MATH 0303 Introductory Algebra 24.00

MATH 0304 Intermediate Algebra 24.00

MATH 0308 Foundation of Statistics 24.00

### **DISTANCE EDUCATION**

XXXX XXXX Internet / Hybrid Class 25.00

XXXX XXXX VCT / TXVSN / Internet Master Courses Charges Vary by External  
Institutional Charges \$0-\$450

### **DRAMA**

DRAM 1120 Theater Practicum I 24.00

DRAM 1121 Theater Practicum II 24.00

DRAM 1330 Stagecraft I 24.00

DRAM 1341 Makeup 24.00

DRAM 1351 Acting I 24.00

DRAM 1352 Acting II 24.00

DRAM 2120 Theater Practicum III 24.00

DRAM 2121 Theater Practicum IV 24.00

DRAM 2331 Stagecraft II 24.00

### **EDUCATION**

EDUC 1301 Intro to the Teaching Profession 24.00

EDUC 2301 Intro to Special Populations 24.00

### **ELECTRICAL & ELECTRONICS TECHNOLOGY**

CETT 1307 Fundamentals of Electronics 24.00 50.00

CETT 1402 Electricity Principles 24.00

CETT 1415 Digital Applications 24.00

CETT 1449 Digital Systems 24.00

CNBT 1402 Mechanical Plumbing & Electrical Systems 24.00

ELPT 1221 Introduction to Electrical Safety & Tools 24.00

ELPT 1325 National Electrical Codes 24.00

ELPT 1311 Basic Electrical Theory 24.00

ELPT 1345 Commercial Wiring 24.00 30.00

ELPT 2319 Programmable Logic Controllers I 24.00

ELPT 2449 Industrial Automation 24.00 30.00

ELPT 2455 Programmable Logic Controllers II 24.00

INTC 1457 AC/DC Motor Control 24.00

### **EMERGENCY MEDICAL SERVICES**

EMSP 1260 Clinical (Basic) 100.00 13.00 30.00

EMSP 1338 Intro to Advanced Practice 24.00



EMSP 1355	Trauma Management	24.00		
EMSP 1356	Patient Assess & Airway Management	24.00		
EMSP 1362	Clinical (Advanced)		100.00	13.00 50.00
EMSP 1501	EMT (Basic)	24.00		80.00
EMSP 2143	Assessment Based Management	24.00		
EMSP 2260	Clinical I-EMT (Paramedic)		100.00	13.00 80.00
EMSP 2261	Clinical II-EMT (Paramedic)		100.00	13.00
EMSP 2264	Practicum (Paramedic)		100.00	13.00
EMSP 2305	EMS Operations	24.00		
EMSP 2306	Emergency Pharmacology	24.00		
EMSP 2430	Special Populations	24.00		
EMSP 2434	Medical Emergencies	24.00		
EMSP 2444	Cardiology	24.00		

## **ENGINEERING**

ENGR 1201	Introduction to Engineering	24.00		
ENGR 1304	Engineering Graphics	24.00		
ENGR 2105	Electrical Circuits Lab	24.00		
ENGR 2401	Engineering Mechanics	24.00		

## **ENVIRONMENTAL SCIENCES**

ENVR 1101	Environmental Science I Lab	24.00		
ENVR 1102	Environmental Science II Lab	24.00		

## **HEALTH AND PHYSICAL EDUCATION**

PHED 1100	Aerobics: Dance	24.00		
PHED 1113	Total Body Fitness I	24.00		
PHED 1114	Total Body Fitness II	24.00		
PHED 1117	Fitness Training: Law Enforcement I	24.00		40.00
PHED 1118	Fitness Training: Law Enforcement II	24.00		40.00
PHED 1133	Introduction to Golf I	24.00		75.00
PHED 1134	Introduction to Golf II	24.00		75.00
PHED 1136	Basketball	24.00		
PHED 1137	Walking and Jogging I	24.00		
PHED 1138	Walking and Jogging II	24.00		
PHED 1139	Indoor Soccer I	24.00		
PHED 1141	Introduction to Volleyball	24.00		
PHED 1142	Yoga I	24.00		
PHED 1143	Yoga II	24.00		
PHED 1144	Strength & Conditioning	24.00		
PHED 1146	Aerobics: Stretch & Tone I	24.00		
PHED 1147	Aerobics: Stretch & Tone II	24.00		
PHED 1148	Weight Training I	24.00		
PHED 1149	Weight Training II	24.00		

PHED 1306	First Aid		9.00
PHED 2100	Fitness Training: Law Enforcement III	24.00	40.00
PHED 2101	Fitness Training: Law Enforcement IV	24.00	40.00
PHED 2114	Swimming I	24.00	30.00
PHED 2115	Swimming II	24.00	30.00
PHED 2116	Surfing I	24.00	160.00
PHED 2117	Surfing II	24.00	160.00
PHED 2139	Indoor Soccer II	24.00	

## **HEATING, VENTILATION, AND AIR CONDITIONING TECHNOLOGY**

ELMT 1411	Solar Fundamentals	24.00	30.00
HART 1307	Refrigeration Principles	24.00	30.00
HART 1345	Gas and Electric Heating	24.00	30.00
HART 1401	Basic Electricity for HVAC	24.00	30.00
HART 1403	Air Conditioning Control Principles	24.00	30.00
HART 1441	Residential Air Conditioning	24.00	30.00
HART 2342	Commercial Refrigeration	24.00	50.00
HART 2401	Air Conditioning & Refrigeration Codes	24.00	95.00
HART 2431	Advanced Electricity for HVAC	24.00	
HART 2434	Advanced Air Conditioning Controls	24.00	
HART 2441	Commercial Air Conditioning	24.00	
HART 1410	HVAC Shop Practices and Tools	24.00	

## **MAGNETIC RESONANCE IMAGING (MRI)**

MRIT 2560	Clinical I (Magnetic Resonance Imaging)	100.00	13.00
MRIT 2561	Clinical II (Magnetic Resonance Imaging)	100.00	13.00
MRIT 2562	Clinical III (Magnetic Resonance Imaging)	100.00	13.00

## **MATHEMATICS**

MATH 1314	College Algebra	24.00	
MATH 1324	Math for Business & Social Sciences	24.00	
MATH 1325	Calculus for Business & Social Science	24.00	
MATH 1332	Contemporary Math I	24.00	
MATH 1342	Elementary Statistical Methods	24.00	
MATH 1350	Math for Teachers I	24.00	
MATH 1351	Math for Teachers II	24.00	
MATH 2305	Discrete Mathematics	24.00	
MATH 2312	Precalculus Math	24.00	
MATH 2318	Linear Algebra	24.00	
MATH 2320	Differential Equations	24.00	
MATH 2321	Linear Algebra & Differential Equations	24.00	
MATH 2413	Calculus I	24.00	
MATH 2414	Calculus II	24.00	

MATH 2415 Calculus II 24.00

**MEDICAL ADMINISTRATION**

HITT 1341 Coding & Classification Systems 24.00

HITT 2313 Working with Health IT Systems 24.00

HITT 2335 Coding & Reimbursement Methodologies 24.00

HITT 2339 Health Information Organization and Supervision 24.00

HITT 2340 Advanced Medical Billing & Reimbursement 24.00

HITT 2346 Advanced Medical Coding 24.00

**MUSIC**

MUAP X1XX Applied Music Individualized Instruction - One 1/2 Hr private lessons per week over the course of a long semester 90.00

MUAP X2XX Applied Music Individualized Instruction - Two 1/2 Hr private lessons per week over the course of a long semester 180.00

MUEN X1XX Music Ensembles 15.00

MUEN X2XX Music Ensembles 24.00

MUSI X1XX Class Voice, Piano, or Guitar 24.00

**NUCLEAR MEDICINE TECHNOLOGY**

NMTT 1162 Clinical (Nuclear Medicine Technology) 100.00 13.00

NMTT 1201 Introduction to Nuclear Medicine Technology 24.00 96.00

NMTT 1211 Nuclear Medicine Patient Care 24.00

NMTT 1309 Nuclear Medicine Technology Instrumentation 24.00

NMTT 2201 Radiochem/Radiopharmacy 24.00

NMTT 2235 Nuclear Medicine Seminar 24.00

NMTT 2361 Practicum I (Nuclear Medicine Technology) 100.00 13.00

NMTT 2467 Practicum II (Nuclear Medicine Technology) 100.00 13.00

NMTT 2466 Practicum III (Nuclear Medicine Technology) 100.00 13.00 96.00

**NURSING (RN) - ASSOCIATE DEGREE**

RNSG 1105 Nursing Skills I 24.00

RNSG 1140 Nursing Skills for Articulating Students 24.00

RNSG 1144 Nursing Skills II 24.00

RNSG 1215 Health Assessment 24.00

RNSG 1413 Foundations for Nursing Practice 24.00 100.00 13.00 254.00

RNSG 1441 Common Concepts of Adult Health 24.00 100.00 13.00

RNSG 1443 Complex Concepts of Adult Health 24.00 100.00 13.00 399.00

RNSG 2201 Care of Children & Families 24.00 100.00 13.00 159.00

RNSG 2208 Maternal/Newborn & Women's Health 24.00

RNSG 2213 Mental Health Nursing 24.00 100.00 13.00 224.00

RNSG 2307 Transition to Nursing Practice 24.00 100.00 13.00 254.00

**PHYSICS**

PHYS 1401 College Physics I 24.00

PHYS	1402	College Physics II	24.00		
PHYS	2425	University Physics I	24.00		
PHYS	2426	University Physics II	24.00		
<b>RADIATION THERAPY</b>					
RADT	1205	Technical Procedures	24.00		
RADT	1266	Practicum I (Radiation Therapy A.A.S.)	100.00	13.00	48.00
RADT	1467	Practicum II (Radiation Therapy-A.A.S.)	100.00	13.00	
RADT	2466	Practicum III (Radiation Therapy A.A.S.)	100.00	13.00	
<b>RADIOGRAPHY</b>					
RADR	1166	Practicum I	100.00	13.00	
RADR	1202	Radiographic Image Evaluation I	24.00		
RADR	1250	Radiographic Image Evaluation II	24.00		
RADR	1267	Practicum II	100.00	13.00	
RADR	1303	Patient Care & Ethics	24.00		
RADR	1309	Intro to Radiography and Patient Care	24.00		
RADR	1367	Practicum I (Radiography)	100.00	13.00	48.00
RADR	1411	Basic Radiography Procedures	24.00		
RADR	2209	Radiographic Imaging Equipment	24.00		
RADR	2305	Principles of Imaging II	24.00		
RADR	2333	Advanced Medical Imaging			24.00
RADR	2335	Radiologic Tech. Seminar			24.00
RADR	2466	Practicum II (Radiography)	100.00	13.00	48.00
RADR	2467	Practicum III (Radiography)	100.00	13.00	
RADR	2401	Intermediate Radiographic Procedures	24.00		
<b>SURGICAL TECHNOLOGY</b>					
SRGT	1260	Clinical I	100.00	13.00	
SRGT	1505	Intro to Surgical Technology	24.00		
SRGT	1509	Fundamentals of Perioperative Concepts and Tech	24.00		
SRGT	1541	Surgical Procedures I	24.00		
SRGT	1542	Surgical Procedures II	24.00		
SRGT	1561	Clinical II	100.00	13.00	
SRGT	1562	Clinical III	100.00	13.00	
<b>VOCATIONAL NURSING</b>					
VNSG	1122	Vocational Nursing Concepts	100.00		267.00
VNSG	1191	Specialty Topic: VN NCLEX Prep			349.00
VNSG	1227	Essentials of Medication Administration	24.00		
VNSG	1230	Maternal/Neonatal Nursing	24.00		
VNSG	1234	Pediatrics	24.00		
VNSG	1262	Clinical (Med-Surg Nsg I)	100.00	13.00	
VNSG	1320	Anatomy & Physiology for Allied Health	24.00		

VNSG 1402	Applied Nursing Skills I	24.00		
VNSG 2313	Applied Nursing Skills II	24.00		
VNSG 2214	Applied Nursing Skills III	24.00		172.00
VNSG 2262	Clinical (Med-Surg Nsg II)		100.00	13.00

## **WELDING**

WLDG 1313	Intro to Blueprint Reading	24.00		
WLDG 1317	Intro to Layout and Fabrication	24.00		42.00
WLDG 1327	Welding Codes and Standards	24.00		42.00
WLDG 1407	Intro to Multiple Process	24.00		42.00
WLDG 1428	Intro to Shielded Metal Arc Welding	24.00		30.00
WLDG 1434	Intro to Gas Tungsten Arc Welding (GTAW)	24.00		30.00
WLDG 1435	Intro to Pipe Welding	24.00		40.00
WLDG 2413	Intermedite Welding Using Multiple Process	24.00		30.00
WLDG 2435	Advanced Layout and Fabrication	24.00		40.00
WLDG 2443	Advanced Shielded Metal Arc Welding (SMAW)	24.00		30.00
WLDG 2451	Advanced Gas Tungsten Arc Welding (GTAW)	24.00		40.00
WLDG 2453	Advanced Pipe Welding	24.00		40.00





# Opening Doors, Changing Lives



"A Beacon of Light Guiding Life Long Learning"



## Galveston College

*"The #1 Community College in Texas"*

**MAIN CAMPUS**

4015 Avenue Q, Galveston, TX 77550

**CHARLIE THOMAS FAMILY  
APPLIED TECHNOLOGY CENTER**

7626 Broadway, Galveston, TX 77554

[www.gc.edu](http://www.gc.edu) | 409-944-GCGC

It is the policy of Galveston College to provide equal opportunities without regard to age, race, color, religion, national origin, sex, disability, genetic information or veteran status.